

**LOS ANGELES COUNTY
DEPARTMENT OF PUBLIC WORKS**

BENCHMARKS



ARCADIA/ROSEMEAD QUAD

**2005 ADJUSTMENT
2005 BASELINE
NAVD 88 DATUM FOOT/METER**

PREFACE

The Department of Public Works level net is composed of more than 1,700 miles or 2720 kilometers of levels supporting in excess of 9,000 benchmarks. Previously when a major readjustment of the net was undertaken, to emphasize the complete break with previous elevations, the CY, CG, and CL, series benchmarks were re-labeled DY, DG, and DL, respectively. Beginning in 1993 the Baseline readjustment year will be indicated on Baseline BM's, as indicated below (*). Henceforth all BM numbers will be labeled as a Y, G, or L series that will no longer indicate the major adjustment year.

To facilitate the adjustment, indexing and distribution of the adjusted values of the net, the county territory was divided into 33 quads or areas. For the identification purposes each quad was given a name (i.e. "Rosemead", "La Mirada", and "Santa Fe"...etc). When benchmarks and elevations in the quad are used, the name of the bench and quad must be stated in the description, i.e.:

| | | | | |
|-----|----------|---------|---------------------------------|--------|
| (*) | BASELINE | 90.057 | L&BR IN CTR OF CB RET @ NE COR | Y 9191 |
| | (1990) | 295.461 | LA HABRA BLVD & VALLEY HOME AVE | |

It is expected that this general adjustment will for the most part remain sound for 8 to 10 years. Updating constrained adjustments will continue in the future. When a quad is readjusted, new elevations will be published and the date of readjustment will be noted in the benchmark description. Two benchmarks with different adjustment dates will not normally agree with each other.

The basic accuracy of the net is reflected by an indicated field probable error of ± 0.017 feet per mile (4mm per kilometer) of leveling as determined from conditions of closure. However, many years of experience in vertical control in the greater Los Angeles basin and Antelope Valley indicates that because of varying degrees of subsidence and heaving, the true datum is recovered only by obtaining substantial agreement of a number of benchmarks.

The users of this network of benchmarks are invited to assist in its maintenance by notifying this department of cases of obliteration, apparent mistakes in descriptions or elevations, and the disturbance of benchmarks.

Datum: North American Vertical Datum of 1988 (NAVD88)

Note: NAVD 1988 minus approximately 2.3 feet (70 cm) equals NGVD 1929 Datum. For more accurate equations at individual benchmarks refer to previous publications.

Abbreviations used in Benchmark Descriptions

| Abbreviations | Descriptions | Abbreviations | Descriptions |
|----------------------|-------------------------|----------------------|------------------------------|
| <i>ABUT</i> | Abutment | <i>LT</i> | Lead and Tack |
| <i>ALG</i> | Along | <i>LACE</i> | Los Angeles City Engineer |
| <i>ANG PT</i> | Angle Point | <i>LACS</i> | La County Engineer |
| <i>B/W</i> | Back of Walk | <i>LAFC</i> | La County Flood Control |
| <i>BCR</i> | Begin Curb Return | <i>L&BN</i> | Lead and Bench Nail |
| <i>BC</i> | Begin Curve | <i>L&BR</i> | Lead and Brad |
| <i>BLDG</i> | Building | <i>L&N</i> | Lead and Nail |
| <i>BM</i> | Benchmark | <i>L&SPK</i> | Lead and Spike |
| <i>BT SPK</i> | Boat or Bolt Spike | <i>L&T</i> | Lead and Tack |
| <i>BR CAP</i> | Brass Cap Monument | <i>MCR</i> | Middle Curb Return |
| <i>C B</i> | Catch Basin | <i>MKD</i> | Marked |
| <i>CTR</i> | Center | <i>MC</i> | Middle Curve |
| <i>C/L</i> | Centerline | <i>MON</i> | Monument |
| <i>C/L INT</i> | Centerline Intersection | <i>N/O</i> | North of |
| <i>C/L PROD</i> | Centerline Produced | <i>NR</i> | Near |
| <i>CONC</i> | Concrete | <i>OPP</i> | Opposite |
| <i>COR</i> | Corner | <i>PI</i> | Point of Intersection |
| <i>COE</i> | Corps of Engineers | <i>PK&W</i> | PK Nail and Washer |
| <i>CULV</i> | Culvert | <i>P/L</i> | Property Line |
| <i>CYN</i> | Canyon | <i>POST</i> | Point on Simi-Tangent |
| <i>CB</i> | Curb | <i>PP</i> | Power Pole |
| <i>CS MON</i> | Co. Eng. Monument | <i>PVMT</i> | Pavement |
| <i>CT SPK</i> | Cut Spike | <i>PROD</i> | Produced |
| <i>DPW</i> | Dept of Public Works | <i>RD</i> | Road |
| <i>DR</i> | Driveway | <i>RDBM</i> | Road Dept Benchmark |
| <i>E/O</i> | East of | <i>RDBM TAG</i> | Road Dept Benchmark Tag |
| <i>ECR</i> | End Curb Return | <i>RR</i> | Railroad |
| <i>EC</i> | End Curve | <i>R/W</i> | Right of Way |
| <i>ENT</i> | Entrance | <i>SDMH</i> | Storm Drain Manhole |
| <i>FL</i> | Flow line | <i>SMH</i> | Sewer Manhole |
| <i>FTG</i> | Footing | <i>SPK</i> | Spike |
| <i>FRWY</i> | Freeway | <i>ST&W</i> | Spike Tin and Washer |
| <i>F/W</i> | Front of Walk | <i>S/O</i> | South of |
| <i>GAR</i> | Garage | <i>TP</i> | Telephone Pole |
| <i>HDWL</i> | Head Wall | <i>USC&GS</i> | US Coast and Geodetic Survey |
| <i>HSE</i> | House | <i>USGS</i> | US Geological Survey |
| <i>HWY</i> | Highway | <i>WK</i> | Walk |
| <i>INT</i> | Intersection | <i>W/O</i> | West of |
| <i>IP</i> | Iron Pipe | | |

QUAD COVERAGE INDEX MAP



ARCADIA-ROSEMEAD QUAD



**NUMBERS REFER TO
THOMAS BROS PAGE
NUMBERS.**

**EACH THOMAS BROS
PAGE IS DIVIDED INTO
TWO INDEX PAGES
EAST AND WEST**

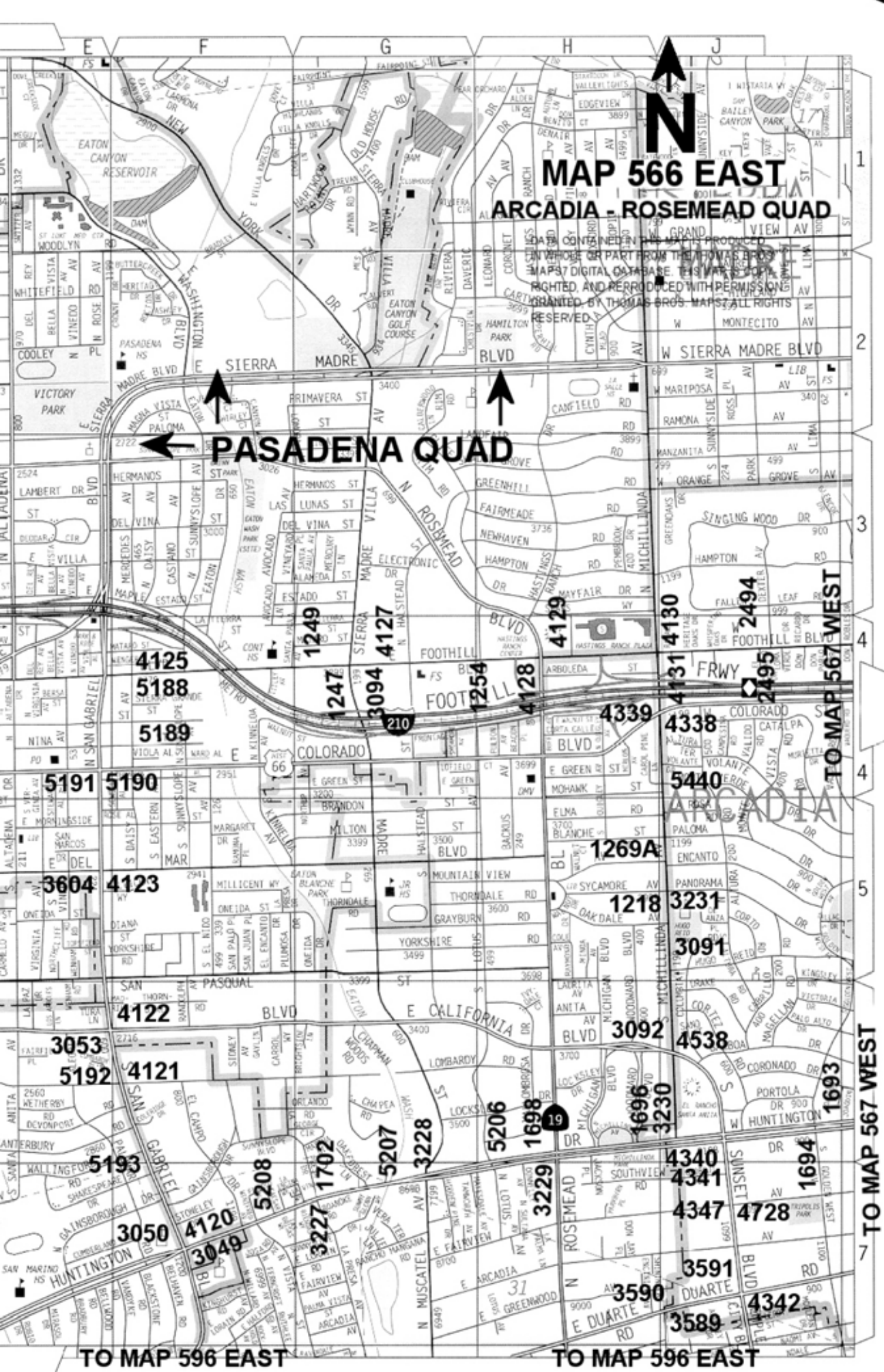

MAP 566 EAST
ARCADIA - ROSEMEAD QUAD

PASADENA QUADEAST



4125
5188
5189

1247
3094
4127

4129
4130

4131
4133
2494
2495

5191
5190
3604
4123

4339
4338
5440
1269A

1218
3231
3091

3053
5192
4121
5193

4538
4539
1696
3230

3227
1702
5207
3228

5206
1698
3229

4340
4341
4347
4728

3050
4120
3049

1694
1693
3591
3590
3589
4342

TO MAP 596 EAST

TO MAP 596 EAST

TO MAP 567 WEST

TO MAP 567 WEST

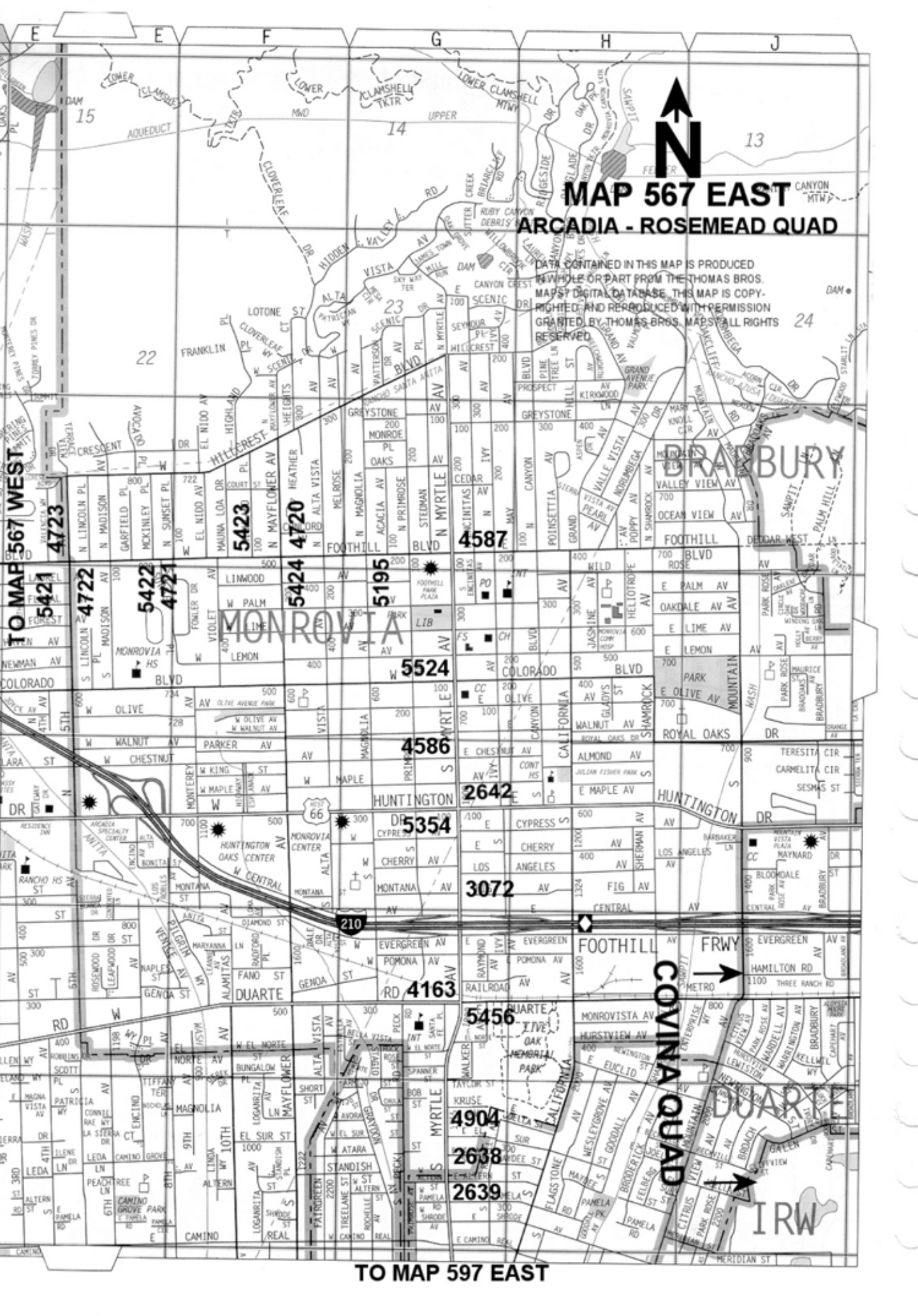

MAP 567 EAST ARCADIA - ROSEMEAD QUAD

DATA CONTAINED IN THIS MAP IS PRODUCED BY WHOLE OR PART FROM THE THOMAS BROS. MAPS DIGITAL DATABASE. THIS MAP IS COPY-RIGHTED AND REPRODUCED WITH PERMISSION GRANTED BY THOMAS BROS. MAPS. ALL RIGHTS RESERVED.

TO MAP 567 WEST

TO MAP 597 EAST

COVINA QUAD

IRW



**MAP 567 WEST
ARCADIA - ROSEMEAD QUAD**

PASADENA QUAD

TO MAP 566 EAST

TO MAP 567 EAST

TO MAP 566 EAST

TO MAP 597 WEST

CONTAINED IN THIS MAP IS PRODUCED IN WHOLE OR PART FROM THE THOMAS BROS. MAPS DIGITAL DATABASE. THIS MAP IS COPY-RIGHTED AND REPRODUCED WITH PERMISSION GRANTED BY THOMAS BROS. MAPS. ALL RIGHTS RESERVED.



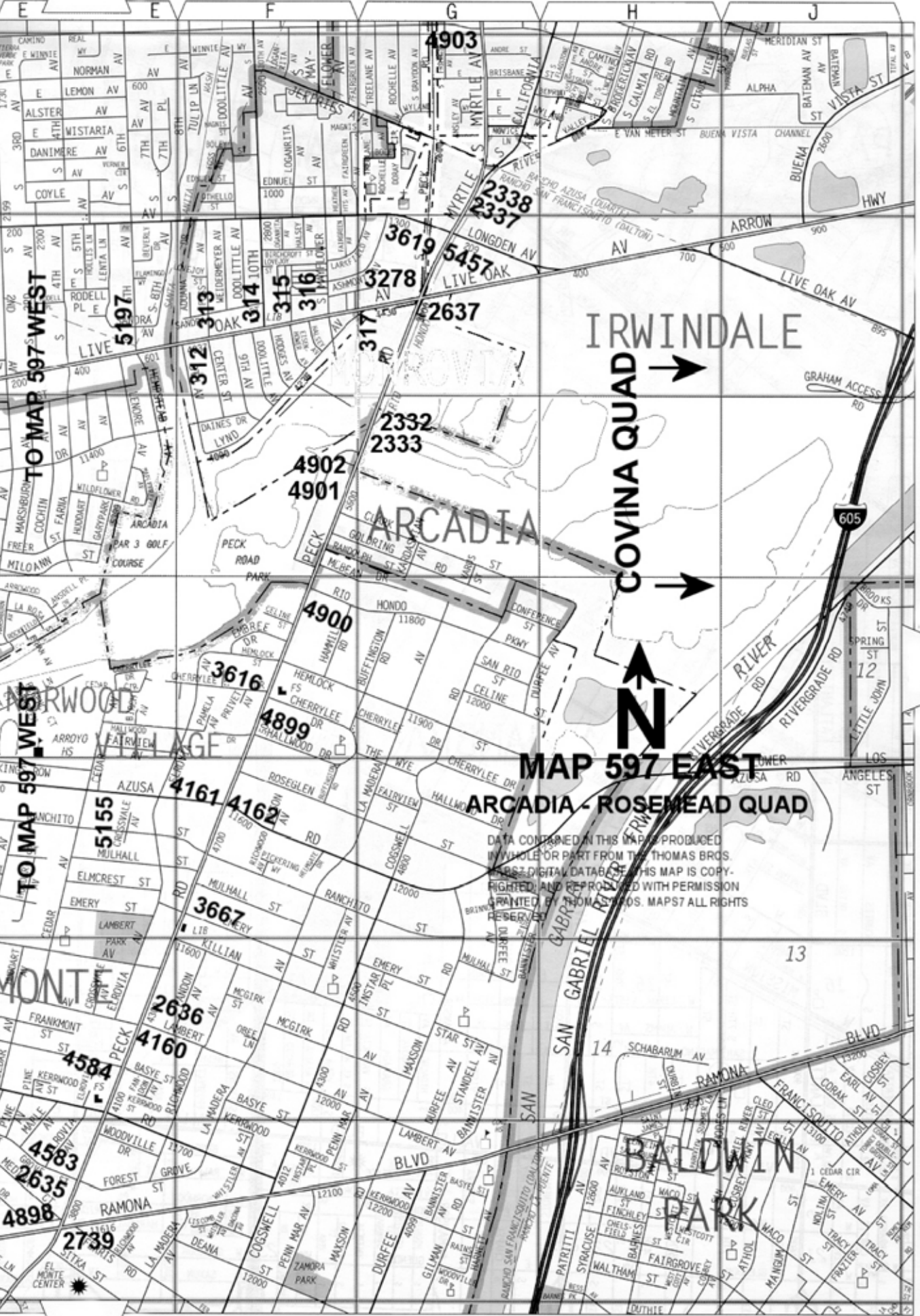

4903

2338
2337

3619
5457

3278
LIVE OAK

2637

5197

312
313

314
315
316

317

2332
2333

4902
4901

ARCADIA

4900

3616

4899

MAP 597 EAST

ARCADIA - ROSEMEAD QUAD

DATA CONTAINED IN THIS MAP IS PRODUCED IN WHOLE OR PART FROM THE THOMAS BRCS 2002 DIGITAL DATABASE. THIS MAP IS COPYRIGHTED AND REPRODUCED WITH PERMISSION GRANTED BY TOMAS BRCS. MAPS7 ALL RIGHTS RESERVED.

13

BALDWIN PARK

TO MAP 597 WEST

IRWINDALE

COVINA QUAD



TO MAP 597 WEST

TO MAP 567 WEST

MAP 597 WEST

ARCADIA ROSEMEAD QUAD

DATA CONTAINED IN THIS MAP WAS PRODUCED LONGBEACH OR PART THEREOF. THIS MAP IS COPY RIGHTED, AND REPRODUCED WITH PERMISSION GRANTED BY THOMAS ARNO ENGINEERING, INC. RESERVED 200

TO MAP 596 EAST

TO MAP 597 EAST

TO MAP 596 EAST

TO MAP 597 EAST

TO MAP 597 EAST

TO MAP 637 WEST

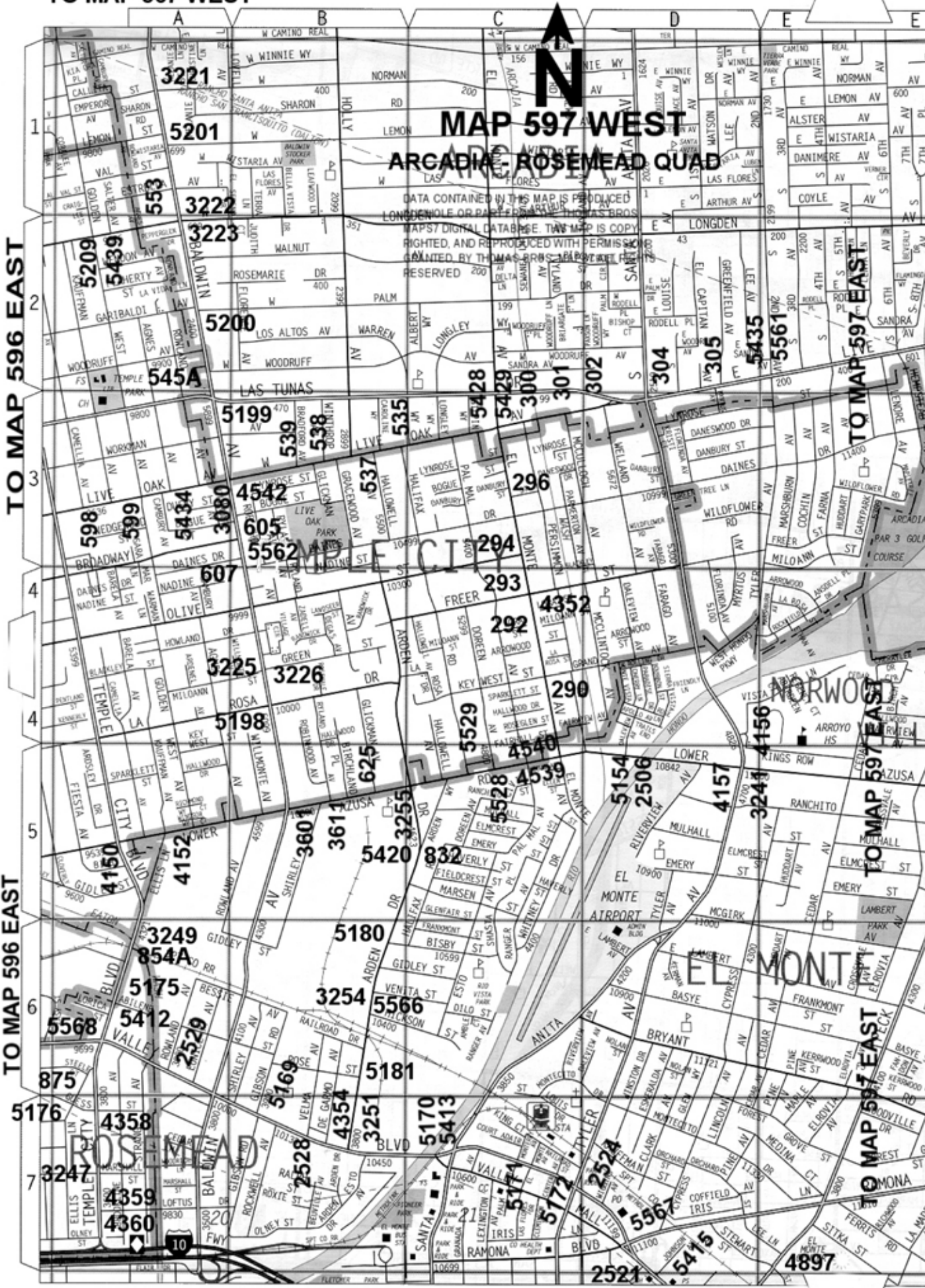

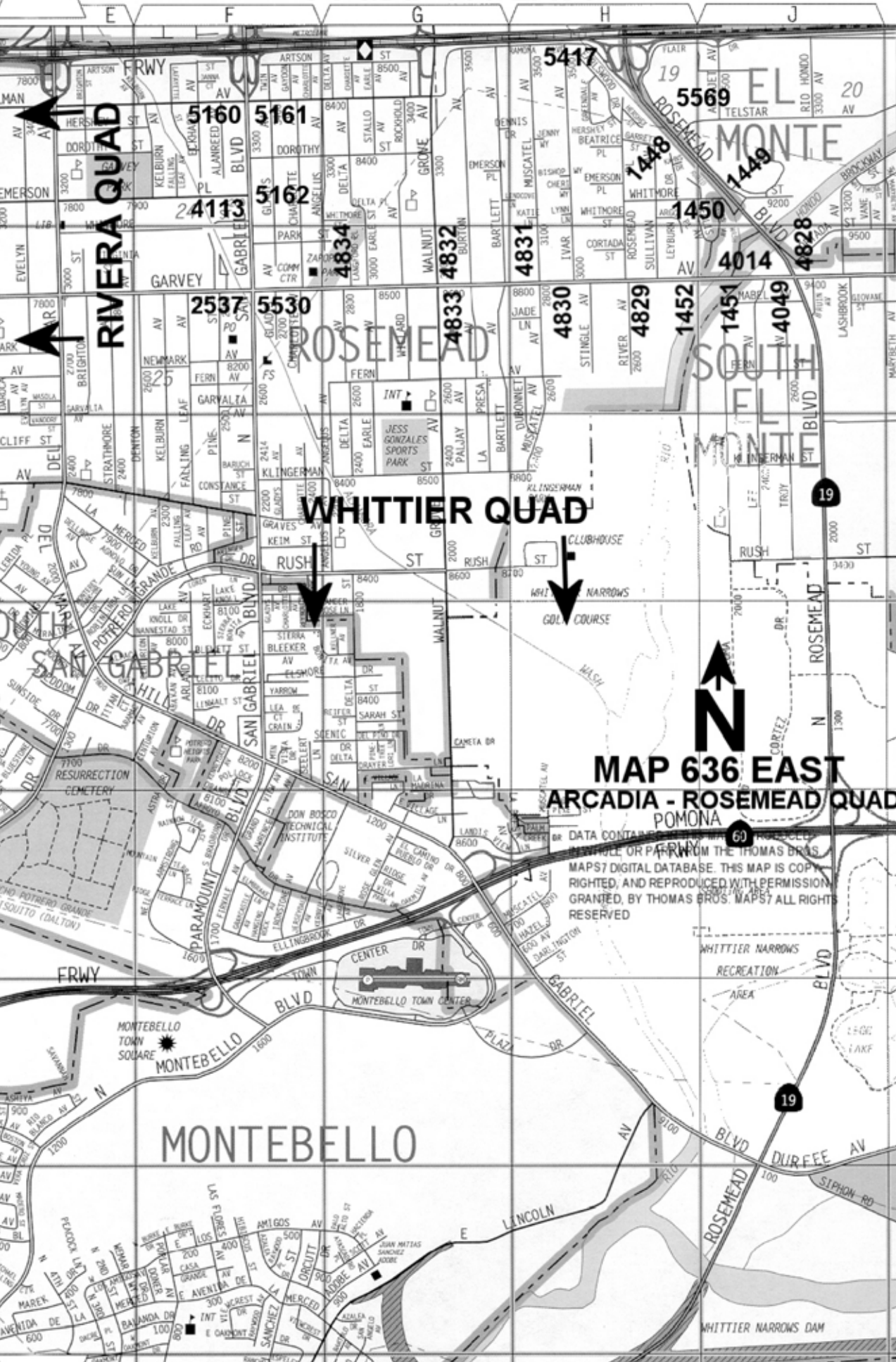

RIVERA QUAD

WHITTIER QUAD



MAP 636 EAST
ARCADIA - ROSEMEAD QUAD

REPRODUCED FROM THE THOMAS BROS. MAPS7 DIGITAL DATABASE. THIS MAP IS COPYRIGHTED, AND REPRODUCED WITH PERMISSION GRANTED, BY THOMAS BROS. MAPS7 ALL RIGHTS RESERVED

MONTEBELLO

WHITTIER NARROWS RECREATION AREA

WHITTIER NARROWS DAM

TO MAP 597 WEST

TO MAP 636 EAST

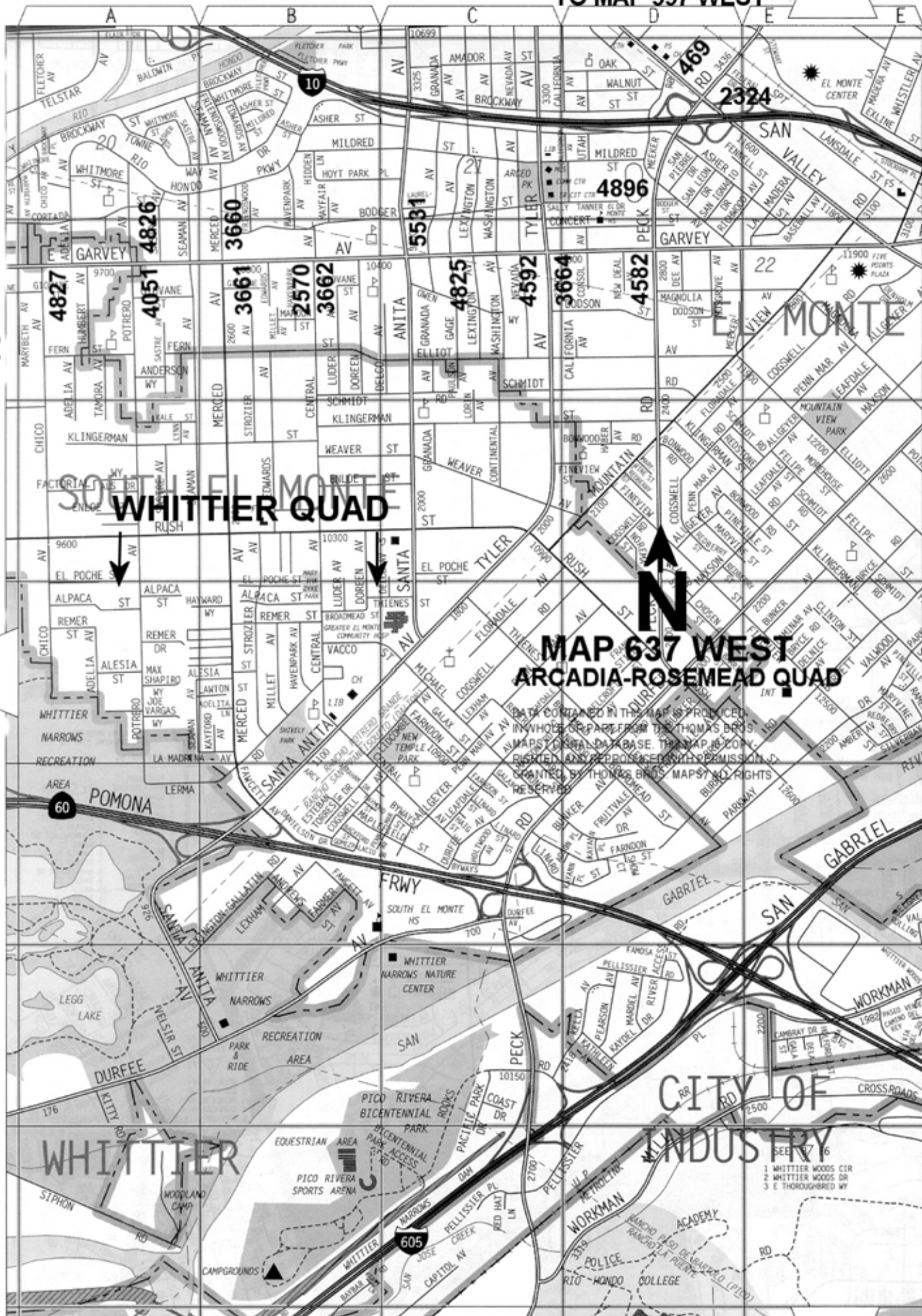

WHITTIER QUAD

**MAP 637 WEST
ARCADIA-ROSEMEAD QUAD**

DATA CONTAINED IN THIS MAP IS PRODUCED IN WHOLE OR PART FROM THE THOMAS BROS. MAPS DIGITAL DATABASE. THIS MAP IS COPY-RIGHTED AND REPRODUCED WITH PERMISSION OF THOMAS BROS. MAPS. NO RIGHTS RESERVED.

- SEE MAP 6
 1 WHITTIER WOODS CIR
 2 WHITTIER WOODS DR
 3 E THOROUGHBRD WY

| QUAD YEAR | ELEV FOOT/METER | DESCRIPTION | BM NUMBER |
|--------------------|--------------------|---|-----------|
| ARCADIA (2005) | 312.046 95.112 | BT SPK IN E CB EL MONTE AVE 7.5M(25FT) N/O DRWY TO HSE #4850 152M(500FT) N/O LOWER AZUSA RD MKD (TE 466) | G 290 |
| ARCADIA (2005) | 325.487 99.209 | BT SPK IN E CB EL MONTE AVE 20M(65FT) N/O C/L PROD MILOANN ST MKD (TE 462) | G 292 |
| ARCADIA (2005) | 329.152 100.326 | BT SPK W CB 1.5M(5FT) S/O BCR @ SW COR EL MONTE AVE & FREER ST MKD (E 461) | G 293 |
| ARCADIA (2005) | 334.949 102.093 | BT SPK IN E CB EL MONTE AVE 8.5M(28FT) S/O C/L PROD OLIVE ST MKD (TE 459) | G 294 |
| ARCADIA (2005) | 343.417 104.674 | BT SPK IN W CB EL MONTE AVE 2M(7FT) S/O C/L PROD DANBURY ST MKD (TE 553) | G 296 |
| ARCADIA (2005) | 353.533 107.757 | PK IN S CB 1.5M(5FT) E/O BCR @ SE COR LIVE OAK AVE & PERSIMMON AVE | G 300 |
| ARCADIA (2005) | 354.258 107.978 | BT SPK IN S CB 2M(6FT) W/O BCR @ SW COR LIVE OAK AVE & MC CULLOCH AVE | G 301 |
| ARCADIA (2005) | 354.625 108.090 | BT SPK IN S CB 2.5M(8FT) W/O BCR @ SW COR LIVE OAK AVE & WELLAND AVE | G 302 |
| ARCADIA (2005) | 351.142 107.028 | BT SPK IN S CB LIVE OAK AVE 6M(20FT) W/O C/L PROD LOUISE AVE MKD (TE 526) | G 304 |
| ARCADIA (2005) | 350.388 106.799 | BT SPK IN S CB 1M(4FT) W/O BCR @ SW COR LIVE OAK AVE & MYRTUS AVE | G 305 |
| ARCADIA (2005) | 349.273 106.459 | L&T IN S CB 1M(3.3FT) W/O BCR @ SW COR LIVE OAK AVE & CENTER AVE | G 312 |
| ARCADIA (2005) | 349.701 106.589 | L&BN IN S CB 1.5M(5FT) E/O BCR @ SW COR LIVE OAK AVE & NINTH AVE | G 313 |
| ARCADIA (2005) | 350.217 106.746 | PK IN N CB (SERV RD) LIVE OAK AVE 5M(16FT) N/O C/L ON C/L PROD 10TH AVE | G 314 |
| ARCADIA (2005) | 350.088 106.707 | L&T IN S CB 300MM(1FT) E/O BCR @ SE COR LIVE OAK AVE (SERV RD) & EISENHOWER AVE 13M(43FT) E/O & 5M(16FT) S/O C/L INT | G 315 |
| ARCADIA (2005) | 351.907 107.262 | L&T IN S CB 300MM(1FT) W/O BCR @ SW COR LIVE OAK AVE & MAYFLOWER AVE | G 316 |
| ARCADIA (2005) | 354.319 107.997 | L&SPK IN S CB LIVE OAK AVE 300MM(1FT) W/O BCR 11.6M(38FT) S/O C/L & 26M(85FT) W/O C/L LYND AVE | G 317 |
| BASELINE (2005) | 285.805 87.114 | NAIL&W IN W END C. B. 1M(3FT) E/O BCR 12M(40FT) N/O C/L VALLEY BLVD & 20M(66FT) E/O C/L PECK RD | G 469 |
| ARCADIA (2005) | 362.276 110.422 | L&PK IN E CB 1.5M(5FT) N/O BCR @ NE COR LIVE OAK AVE & WARREN WAY MKD (TE 512) | G 535 |
| ARCADIA (2005) | 366.069 111.578 | L&SPK IN E CB 3M(10FT) N/O BCR @ NE COR LIVE OAK AVE & HOLLY AVE MKD (TE 508) | G 537 |
| ARCADIA (2005) | 368.867 112.431 | PK IN W CB 1.5M(5FT) N/O BCR @ NW COR LIVE OAK AVE & WINTHROP AVE | G 538 |
| ARCADIA (2005) | 372.034 113.396 | PK IN W CB 1.5M(5FT) N/O BCR @ NW COR LIVE OAK AVE & BRADFORD AVE | G 539 |

| QUAD YEAR | ELEV FOOT/METER | DESCRIPTION | BM NUMBER |
|--------------------|--------------------|--|-----------|
| ARCADIA (2005) | 390.303 118.965 | L&BN IN S CB 4.5M(15FT) E/O BCR @ SE COR BALDWIN AVE & LAS TUNAS DR | G 545A |
| ARCADIA (2005) | 432.948 131.963 | L&T 300MM(1FT) E/O W EDGE CONC DRWY TO HSE #9846 LONGDEN AVE 4.5M(15FT) S/O CF 10.5M(34FT) S/O C/L & 5.5M(18FT) W/O C/L PROD AGNES AVE | G 553 |
| ARCADIA (2005) | 449.722 137.076 | L&SPK IN S CB 1M(4FT) E/O BCR @ SE COR LONGDEN AVE & OAK AVE | G 561 |
| ARCADIA (2005) | 451.516 137.622 | L&SPK IN W CB ENCINITA AVE 5.5M(18FT) W & 40M(131FT) S/O C/L INT LONGDEN AVE @ HSE #6261 | G 563 |
| ARCADIA (2005) | 440.731 134.335 | L&BN IN N CB 1M(3FT) W/O BCR @ NW COR ROSEMEAD BLVD & GARIBALDI AVE | G 572 |
| ARCADIA (2005) | 439.209 133.871 | BT SPK IN E CB 2M(6FT) S/O BCR @ SE COR ROSEMEAD BLVD & GARIBALDI AVE | G 573 |
| ARCADIA (2005) | 430.046 131.078 | L&BN IN W CB 2.5M(8FT) N/O C/L DRWY TO HSE #5947 ROSEMEAD BLVD | G 574 |
| ARCADIA (2005) | 414.964 126.481 | L&SPK IN E CB 2M(6FT) S/O BCR @ SE COR ROSEMEAD BLVD & ELM AVE (TE 136) | G 576 |
| ARCADIA (2005) | 388.967 118.557 | L&SPK IN E CB 3.7M(12FT) N/O BCR @ NE COR RIO HONDO AVE & LIVE OAK AVE | G 590 |
| ARCADIA (2005) | 389.425 118.697 | L&SPK IN W CB 8.5M(28FT) N/O BCR @ NW COR LIVE OAK AVE & ALESSANDRO AVE | G 591 |
| ARCADIA (2005) | 388.471 118.406 | L&SPK IN W CB 4.5M(15FT) N/O BCR @ NW COR LIVE OAK AVE & OAK AVE MKD (TE-26) | G 592 |
| ARCADIA (2005) | 386.707 117.869 | L&SPK IN W CB 3M(10FT) N/O BCR @ NW COR LIVE OAK AVE & CLOVERLY AVE | G 593 |
| ARCADIA (2005) | 383.359 116.848 | L&BN IN E CB 11.5M(38FT) N/O BCR @ NE COR LIVE OAK AVE & CAMELLIA AVE | G 598 |
| ARCADIA (2005) | 382.381 116.550 | L&SPK IN W CB 7M(23FT) N/O BCR @ NW COR LIVE OAK AVE & KAUFFMAN AVE | G 599 |
| ARCADIA (2005) | 363.724 110.863 | L&T IN W CB 300MM(1FT) S/O BCR @ SW COR BALDWIN AVE & BROADWAY | G 605 |
| ARCADIA (2005) | 360.105 109.760 | L&T IN W CB 300MM(1FT) S/O BCR @ SW COR BALDWIN AVE & DAINES DR | G 607 |
| BASELINE (2005) | 312.549 95.265 | L&SPK IN E CB 1M(3FT) N/O BCR @ NE COR BIRCHLAND PL & LOWER AZUSA RD | G 625 |
| BASELINE (2005) | 333.096 101.528 | USC&GS DISK IN W CONC CHANNEL WALL @ SW COR BRIDGE OVER EATON CYN WASH 10.5M(34FT) S/O C/L LOWER AZUSA RD & 61M(203FT) W/O C/L RIO HONDO AVE MKD (S 1142 1961) | G 644 |
| ARCADIA (2005) | 350.593 106.861 | L&SPK IN W CB ROSEMEAD BLVD (SERV RD) & GRAND AVE 2M(6FT) S/O BCR 7.5M(25FT) S/O & 3.5M(12FT) W/O C/L INT MKD (WM3) | G 668 |
| ARCADIA (2005) | 355.406 108.328 | L&BN 300MM(1FT) UP ON TOP S WALL @ W END SPRR BRIDGE OVER ROSEMEAD BLVD 21M(70FT) N/O C/L GRAND AVE | G 669 |
| ARCADIA (2005) | 375.972 114.597 | SPK IN E CB 3M(10FT) N/O BCR @ NE COR ROSEMEAD BLVD & SERENO DR | G 671 |

| QUAD YEAR | ELEV FOOT/METER | DESCRIPTION | BM NUMBER |
|--------------------|--------------------|--|-----------|
| ARCADIA (2005) | 385.144 117.392 | FC DISC 1.5M(5FT) E/O E CF @ NE COR BRIDGE @ SE COR ROSEMEAD BLVD & OLIVE ST 18M(59FT) S/O & 14M(46FT) E/O C/L INT 1M(4FT) S/O BCR MKD (59-35) | G 672 |
| ARCADIA (2005) | 397.775 121.242 | L&T IN W CB 11M(35FT) S/O BCR @ SW COR BROADWAY & MUSCATEL AVE | G 676 |
| ARCADIA (2005) | 401.897 122.499 | L&T IN S CB 300MM(1FT) E/O BCR @ SE COR BROADWAY & N LA PRESA AVE | G 677 |
| ARCADIA (2005) | 401.863 122.488 | L&T IN WALK 300MM(1FT) W/O BCR 2M(6.5FT) S/O S CF @ SW COR BROADWAY & WALNUT GROVE AVE 11M(36FT) W/O & 9M(30FT) S/O C/L INT | G 679 |
| ARCADIA (2005) | 400.754 122.150 | L&T IN W CB 1M(3FT) N/O BCR @ NW COR BROADWAY & CHARLOTTE AVE | G 704 |
| ARCADIA (2005) | 400.709 122.136 | L&T IN E CB 1M(3FT) N/O BCR @ NE COR BROADWAY & CHARLOTTE AVE | G 705 |
| ARCADIA (2005) | 449.333 136.957 | SPK IN S CB 2M(6.5FT) E/O BCR @ SE COR SAN GABRIEL BL & HERMOSA DR MKD (BM 224) | G 711 |
| ARCADIA (2005) | 454.037 138.391 | SPK IN E CB 1.5M(5FT) S/O BCR @ SE COR SAN GABRIEL BLVD & LESLIE DR | G 712 |
| ARCADIA (2005) | 459.211 139.968 | L&T IN S CB 600MM(2FT) E/O BCR @ SE COR SAN GABRIEL BLVD & SANTA YNEZ ST | G 713 |
| ARCADIA (2005) | 464.104 141.459 | L&T IN S CB 1M(3.3FT) E/O BCR @ SE COR SAN GABRIEL BLVD & BEVAN | G 714 |
| ARCADIA (2005) | 468.925 142.929 | SPK IN E CB 2M(6.5FT) S/O BCR @ SE COR GARIBALDI AVE & SAN GABRIEL BLVD MKD (BM 228) | G 715 |
| ARCADIA (2005) | 478.248 145.770 | SPK IN S CB LONGDEN AVE 1.5M(5FT) E/O C/L PROD CHARLOTTE AVE MKD (TE 612) | G 720 |
| ARCADIA (2005) | 476.791 145.326 | SPK IN S CB LONGDEN AVE 1.5M(5FT) W/O C/L PROD LONGMONT AVE MKD (TE 611) | G 721 |
| ARCADIA (2005) | 471.706 143.776 | L&T IN N CB 300MM(1FT) E/O BCR @ NE COR LONGDEN AVE & DEL LOMA AVE | G 722 |
| ARCADIA (2005) | 470.128 143.295 | L&BN IN S CB 300MM(1FT) E/O BCR @ SE COR LONGDEN AVE & WILLARD AVE | G 724 |
| ARCADIA (2005) | 471.677 143.768 | L&BN N CB 300MM(1FT) W/O BCR @ NW COR LONGDEN AVE & DEERFIELD AVE MKD (TE 608) | G 725 |
| ARCADIA (2005) | 472.831 144.119 | L&BN IN N CB 1.5M(5FT) W/O BCR @ NW COR LONGDEN AVE & VISTA ST (N) | G 726 |
| ARCADIA (2005) | 471.790 143.802 | L&BN IN E CB 300MM(1FT) S/O BCR @ SE COR LONGDEN AVE & BION AVE MKD (TE 607) | G 727 |
| BASELINE (2005) | 367.982 112.161 | L&T IN W CB 7FT S/O BCR @ SW COR SAN GABRIEL BLVD & MISSION DR 38FT W & 30FT S/O C/L INT | G 748 |
| BASELINE (2005) | 364.302 111.040 | L&T IN W CB 1M(3.3FT) S/O BCR @ SW COR FAIRVIEW AVE & SAN GABRIEL BLVD | G 750 |

| QUAD YEAR | ELEV FOOT/METER | DESCRIPTION | BM NUMBER |
|--------------------|--------------------|--|-----------|
| BASELINE (2005) | 358.823 109.370 | L&T IN W CB 1M(3.3FT) N/O BCR @ NW COR SAN GABRIEL BLVD & CENTRAL AVE | G 752 |
| BASELINE (2005) | 351.928 107.268 | L&T IN W CB 600MM(2FT) N/O BCR @ NW COR SAN GABRIEL BLVD & CHESTNUT AVE | G 753 |
| ARCADIA (2005) | 492.565 150.134 | SPK IN W CB 2M(6.5FT) N/O BCR @ NW COR LOS OLIVOS DR & SAN GABRIEL BLVD MKD (TE 615) | G 775 |
| ARCADIA (2005) | 498.747 152.019 | SPK IN W CB 3M(10FT) N/O BCR @ NW COR SAN GABRIEL BL & SOMERSET PL MKD (TE 616) | G 776 |
| ARCADIA (2005) | 506.597 154.411 | SPK IN W CB 2M(6.5FT) S/O BCR @ SW COR SHEFFIELD RD & SAN GABRIEL BLVD MKD (TE 617) | G 777 |
| ARCADIA (2005) | 508.541 155.004 | SPK IN E CB 2.5M(8.2FT) N/O BCR @ NE COR SHEFFIELD RD & SAN GABRIEL BLVD MKD (TE 618) | G 779 |
| ARCADIA (2005) | 516.017 157.282 | SPK IN W CB 3M(10FT) N/O BCR @ NW COR SAN GABRIEL BL & WOODLAWN AVE MKD (TE 619) | G 780 |
| ARCADIA (2005) | 491.798 149.900 | L&SPK IN E CB @ HSE #6734 OAK AVE & 3.5M(12FT) N/O C/L PROD ARDENDALE AVE MKD (TE 353) | G 809 |
| ARCADIA (2005) | 485.126 147.867 | L&SPK IN E CB OAK AVE 1.5M(5FT) S/O C/L PROD CAMINO REAL (TO THE W) MKD (TE 355) | G 811 |
| ARCADIA (2005) | 474.087 144.502 | SPK IN E CB OAK AVE 1M(3FT) N/O C/L PROD EMPEROR AVE (TO THE W) MKD (TE 357) | G 813 |
| ARCADIA (2005) | 468.719 142.866 | L&SPK IN E CB 600MM(2FT) S/O BCR @ SE COR OAK AVE & LEMON AVE MKD (TE199) | G 814 |
| ARCADIA (2005) | 469.303 143.044 | RDBM TAG IN E CB 15M(50FT) N/O BCR @ NE COR BALDWIN AVE & CAMINO REAL AVE | G 825B |
| ROSEMEAD (2005) | 297.395 90.646 | RE TAG #2000 IN E CB @ ANG PT SLY P/L TO HSE #4544 34M(111FT) S/O & 9M(30FT) E/O C/L INT ARDEN DR & ARDEN WAY | G 832 |
| ROSEMEAD (2005) | 302.411 92.175 | RDBM TAG IN SE COR OF BRIDGE OVER EATON CYN WASH 9.5M(31FT) E/O C/L TEMPLE CITY BLVD & 20M(65FT) N/O SPRR TRACKS | G 854A |
| ROSEMEAD (2005) | 281.133 85.690 | L&SPK IN E CB ELLIS LANE NEAR C/L PROD STEELE ST | G 875 |
| ROSEMEAD (2005) | 275.395 83.941 | L&SPK IN E CB 3M(10FRT) S/O BCR @ SE COR DE ADALENA ST & RIO HONDO AVE | G 883 |
| ROSEMEAD (2005) | 282.207 86.017 | L&BN IN N CB 300MM(1FT) E/O BCR @ NE COR ROSEMEAD BLVD & GLENDON WAY | G 891 |
| ROSEMEAD (2005) | 283.612 86.445 | L&BN IN N CB 3M(10FT) W/O BCR @ NW COR ROSEMEAD BLVD & GLENDON WAY | G 892 |
| ROSEMEAD (2005) | 325.050 99.076 | CS MON IN WELL ON C/L MUSCATEL AVE 30.5M(100FT) N/O C/L VALLEY BLVD MKD (RE 329) | G 906 |
| ROSEMEAD (2005) | 290.407 88.516 | L&SPK IN W CB 1.5M(5FT) S/O BCR @ SW COR RIO HONDO AVE & GUESS ST | G 910 |
| ROSEMEAD (2005) | 291.716 88.915 | L&SPK IN E CB 1.5M(5FT) N/O BCR @ NE COR RIO HONDO AVE & GUESS ST | G 911 |

| QUAD YEAR | ELEV FOOT/METER | DESCRIPTION | BM NUMBER |
|--------------------|--------------------|---|-----------|
| ROSEMEAD (2005) | 298.386 90.948 | L&SPK IN W CB 1M(3FT) S/O BCR @ SW COR RIO HONDO AVE & STEELE ST | G 912 |
| ARCADIA (2005) | 603.771 184.030 | CSBM MON IN WELL 300MM(1FT) W/O & 300MM(1FT) N/O BCR @ NW COR MICHILLINDA AVE & SYCAMORE ST MKD (BM 20-8 1952 RE 63) | G 1218 |
| BASELINE (2005) | 716.650 218.436 | L&BN IN E CB 9M(29.5FT) N/O BCR @ NE COR FOOTHILL BLVD & SIERRA MADRE VILLA | G 1247 |
| BASELINE (2005) | 723.090 220.398 | RAMSET IN S CB 300MM(1FT) W/O BCR @ NW COR SANTA PAULA AVE & FOOTHILL BLVD | G 1249 |
| BASELINE (2005) | 689.945 210.296 | L&BN IN S CB FOOTHILL BLVD 10.5M(34FT) S/O C/L IN CTR OF C. B. @ BLDG #3600 161M(530FT) W/O ROSEMEAD BLVD | G 1254 |
| ARCADIA (2005) | 615.676 187.659 | L&BN IN W CB 300MM(1FT) N/O BCR @ NW COR MICHILLINDA AVE & BLANCHE AVE | G 1269A |
| BASELINE (2005) | 309.765 94.417 | SPK IN W CB 2.5M(8FT) S/O BCR @ SW COR MARSHALL ST & SAN GABRIEL BLVD | G 1439 |
| ROSEMEAD (2005) | 253.163 77.164 | L&BN IN W CB (SERV RD) ROSEMEAD BLVD 4.5M(15FT) S/O BCR 33.5M(110FT) S/O & 5.5M(18FT) W/O C/L INT WITH TELSTAR AVE | G 1448 |
| ROSEMEAD (2005) | 247.978 75.584 | L&BN IN E CB 300MM(1FT) N/O BCR @ NE COR ROSEMEAD BLVD & WHITMORE AVE | G 1449 |
| ROSEMEAD (2005) | 248.744 75.817 | L&BN IN E CB 1.5M(5FT) S/O BCR @ SE COR ROSEMEAD BLVD & WHITMORE AVE | G 1450 |
| BASELINE (2005) | 249.286 75.983 | FC BM MON IN NE ABUT OF BRIDGE OVER RIO HONDO RIVER 1M(3.3FT) N/O CF 12.5M(41FT) N/O C/L GARVEY AVE MKD (57-13) | G 1451 |
| BASELINE (2005) | 251.401 76.627 | FC BM MON IN NW ABUT OF BRIDGE OVER RIO HONDO RIVER 1M(3.3FT) N/O CF 12.5M(41FT) N/O C/L GARVEY AVE MKD (57-11) | G 1452 |
| ARCADIA (2005) | 525.526 160.181 | RDBM TAG IN N CB C/L MEDIAN 300MM(1FT) W/O ANG PT 9M(30FT) S/O C/L HUNTINGTON DR (N BBL) & 15M(50FT) W/O C/L GOLDEN WEST AVE | G 1693 |
| ARCADIA (2005) | 525.905 160.296 | L&T IN N CB 1M(3FT) W/O BCR 9M(30FT) N/O C/L HUNTINGTON DR (N BARREL) & 16.5M(54FT) W/O C/L GOLDEN WEST AVE | G 1694 |
| ARCADIA (2005) | 552.725 168.471 | CSBM MON IN WELL 300MM(1FT) DN 300MM(1FT) N/O CF @ BCR @ NW COR HUNTINGTON DR & MICHILLINDA AVE MKD (BM 20-7 1952 RE 63) | G 1696 |
| ARCADIA (2005) | 565.821 172.463 | SQ HD SPK IN W CB 14M(45FT) N/O BCR @ NW COR ROSEMEAD BLVD & HUNTINGTON DR N | G 1698 |
| ARCADIA (2005) | 589.897 179.801 | BT SPK IN W CB 7.5M(25FT) N/O BCR NR S END C. B. @ NW COR LA PRESA DR & HUNTINGTON DR (N BBL) | G 1702 |
| BASELINE (2005) | 285.039 86.880 | CS MON IN WELL 450MM(1.5FT) N/O CF VALLEY BLVD 300MM(1FT) E/O BCR 12.5M(41FT) N/O C/L & 19.5M(64FT) E/O C/L PECK RD MKD (BM 15-1 1952) NR W END C. B. | G 2324 |
| BASELINE (2005) | 340.914 103.911 | FC MON IN N END OF BRIDGE #B1270 12M(39FT) W/O C/L PECK RD & 305M(0.2MI) N/O CLARK ST MKD (BM 67-75 1959) | G 2332 |
| BASELINE (2005) | 341.597 104.119 | RDBM TAG IN CONC CH WALL 1.5M(5FT) E/O CF @ NE COR BRIDGE #B1270 13.5M(44.3FT) E/O C/L PECK RD & 305M(0.2MI) N/O C/L CLARK ST | G 2333 |

| QUAD YEAR | ELEV FOOT/METER | DESCRIPTION | BM NUMBER |
|--------------------|--------------------|--|-----------|
| BASELINE (2005) | 366.579 111.734 | L&T IN E CB MYRTLE AVE 12M E C/L 11.5M(38FT) S/O BCR OF ISLAND & 20M(65.6FT) S/O C/L CALIFORNIA AVE EXIT | G 2337 |
| BASELINE (2005) | 367.488 112.011 | FC TAG IN W CB 1.5M(5FT) S/O NLY MOST C. B. 12M(39FT) W/O C/L MYRTLE AVE & 16M(52.5FT) N/O C/L PROD CALIF AVE W | G 2338 |
| BASELINE (2005) | 668.997 203.911 | SPK&W IN N CB 300MM(1FT) E/O BCR @ NE COR FOOTHILL BLVD & DEXTER AVE MKD BM | G 2494 |
| BASELINE (2005) | 672.355 204.934 | L&BN IN E CB 300MM(1FT) S/O BCR @ NE COR DEXTER AVE & FOOTHILL BLVD (N SERV RD) 7.5M(24.6FT) N/O & 6.5M(21.3FT) E/O C/L INT | G 2495 |
| ARCADIA (2005) | 568.673 173.332 | SM SPK IN N CB 10M(32FT) E/O BCR @ NE COR BALDWIN AVE & CAMBRIDGE DR | G 2505 |
| BASELINE (2005) | 310.914 94.767 | FC BM MON IN NE COR BRIDGE OVER RIO HONDO RIVER 10M(32FT) N/O C/L LOWER AZUSA RD & 141M(462FT) E/O C/L DALEVIEW AVE MKD (62-128 1959) | G 2506 |
| ROSEMEAD (2005) | 284.904 86.839 | L&TAG(NO#) IN C. B. 2M(6.5FT) E/O BCR @ NE COR VALLEY BLVD & JOHNSON AVE | G 2521 |
| ROSEMEAD (2005) | 289.307 88.181 | L&BR IN N CB 2M(6.5FT) W/O BCR @ NW COR VALLEY BLVD & TYLER AVE | G 2524 |
| ROSEMEAD (2005) | 278.150 84.780 | L&T IN N CB 300MM(1FT) E/O BCR @ NW COR VALLEY BLVD & VELMA ST | G 2528 |
| ROSEMEAD (2005) | 278.524 84.894 | L&T IN N CB 300MM(1FT) E/O BCR @ NW COR VALLEY BLVD & ROWLAND AVE | G 2529 |
| BASELINE (2005) | 328.903 100.250 | L&BN IN W CB 300MM(1FT) S/O BCR @ SW COR SAN GABRIEL BLVD & VALLEY BLVD | G 2534 |
| BASELINE (2005) | 278.225 84.803 | FC BM MON IN W WINGWALL 22.5M(74FT) N/O C/L GARVEY AVE & 69M(226FT) W/O C/L SAN GABRIEL BLVD MKD (BM 55-24) 34FT N/O CF | G 2537 |
| BASELINE (2005) | 264.992 80.770 | CSBM MON IN WELL 600MM(2FT) S/O S CF 46M(151FT) E/O BCR & SE COR GARVEY AVE & CENTRAL AVE MKD (12-7 1952 RE 63) | G 2570 |
| BASELINE (2005) | 298.743 91.057 | CSBM MON IN WELL 300MM(1FT) E/O CF @ SE COR PECK RD & FORREST GROVE ST 22M(71FT) S/O & 12.5M(41FT) E/O C/L INT MKD (BM 15-2A 1963) | G 2635 |
| BASELINE (2005) | 315.863 96.275 | CSBM MON IN CONC LT BASE 3.5M(11.5FT) W/O W CF @ SW COR PECK RD & LAMBERT AVE 15.5M(51FT) W/O & 12M(39.5FT) S/O C/L INT MKD (15-3A 1963 RE 5869) | G 2636 |
| BASELINE (2005) | 356.226 108.578 | FC MON IN S END W WINGWALL OF BRIDGE #944 @ SE COR PECK RD & LIVE OAK ST 25M(82FT) E/O & 14.5M(47.6FT) S/O APPROX C/L INT MKD (67-76 1959) | G 2637 |
| BASELINE (2005) | 389.176 118.621 | L&SPK IN W CB 2M(6.5FT) S/O BCR @ SW COR MYRTLE AVE & ALTERN ST | G 2638 |
| BASELINE (2005) | 389.874 118.834 | L&SPK IN S CB 3M(10FT) E/O BCR @ SE COR MYRTLE AVE & E ALTERN ST | G 2639 |
| BASELINE (2005) | 501.918 152.985 | CSBM MON IN E END C. B. 21M(69FT) E/O BCR @ SE COR MYRTLE AVE & HUNTINGTON DR MKD (11-10A 1962 RE 5869) | G 2642 |
| BASELINE (2005) | 298.453 90.969 | L&BR IN N CB 13.5M(44FT) E/O BCR @ NE COR PECK RD & RAMONA BLVD | G 2739 |

| QUAD YEAR | ELEV FOOT/METER | DESCRIPTION | BM NUMBER |
|--------------------|--------------------|--|-----------|
| ROSEMEAD (2005) | 259.325 79.042 | L&T IN S CB OLNEY ST ON C/L PROD VANE AVE | G 3015 |
| ROSEMEAD (2005) | 259.684 79.152 | L&T IN N CB 2.5M(8FT) W/O BCR @ NE COR OLNEY ST & VANE AVE | G 3016 |
| BASELINE (2005) | 309.727 94.405 | STATE HWY BR DISC FL IN CTR DIVIDER STRIP C/L SAN GABRIEL BLVD 88M(290FT) S/O C/L MARSHALL ST (FR THE E) | G 3027 |
| BASELINE (2005) | 338.548 103.190 | L&T IN E CB 3M(10FT) S/O BCR @ SE COR ROSEMEAD BLVD & LOWER AZUSA RD | G 3029 |
| ROSEMEAD (2005) | 318.031 96.936 | BT SPK IN E CB 3M(10FT) S/O BCR @ SE COR ROSEMEAD BLVD & VALLEY BLVD | G 3035 |
| ARCADIA (2005) | 386.352 117.760 | L&T IN E CB 3M(10FT) S/O BCR @ SE COR SAN GABRIEL BLVD & EL MONTE ST | G 3040 |
| ARCADIA (2005) | 407.912 124.332 | L&BN IN E CB 3.5M(11FT) S/O BCR @ SE COR BROADWAY & SAN GABRIEL BLVD | G 3042 |
| ARCADIA (2005) | 408.762 124.591 | L&BR IN W CB 3.5M(12FT) N/O BCR @ NW COR BROADWAY & SAN GABRIEL BLVD (IN CTR C. B.) | G 3043 |
| ARCADIA (2005) | 414.908 126.464 | FC BM DISC IN NW BRIDGE ABUT OVER RUBIO WASH 15M(49FT) W/O & 19M(62FT) S/O C/L INT SAN GABRIEL BLVD & WEDGEWOOD PL MKD (BM 58-523) | G 3044 |
| ARCADIA (2005) | 600.355 182.989 | L&BN IN S CB 18M(59FT) W/O BCR @ SW COR HUNTINGTON DR & SAN GABRIEL BLVD | G 3049 |
| ARCADIA (2005) | 600.002 182.881 | L&BN IN N CB 7.5M(25FT) E/O BCR @ NE COR HUNTINGTON DR & SAN GABRIEL BLVD | G 3050 |
| BASELINE (2005) | 663.599 202.266 | SPK IN E CB 2M(6.5FT) S/O BCR @ SE COR CALIFORNIA BLVD & SAN GABRIEL BLVD | G 3053 |
| ARCADIA (2005) | 541.732 165.120 | MWD MON IN NE COR OF BRIDGE OVER SANTA ANITA WASH 15M(49FT) N/O C/L FOOTHILL BLVD & 84M(276FT) E/O C/L HIGHLAND OAKS MKD (53 K 1933) | G 3062 |
| BASELINE (2005) | 472.844 144.123 | L&N IN W CB 1.5M(5FT) N/O BCR @ NW COR MONTANNA AVE & MYRTLE AVE | G 3072 |
| ARCADIA (2005) | 376.121 114.642 | L&BN IN W CB 3.5M(11FT) S/O BCR @ SW COR LIVE OAK AVE & BALDWIN AVE | G 3080 |
| ARCADIA (2005) | 504.838 153.875 | L&T IN W CB 300MM(1FT) S/O BCR @ SW COR BALDWIN AVE & HUGO REID DR | G 3083 |
| ARCADIA (2005) | 585.253 178.386 | SPK IN W CB MICHILLINDA AVE 1.5M(5FT) N/O C/L PROD HUGO REID DR MKD(TE431) | G 3091 |
| ARCADIA (2005) | 562.941 171.585 | SPK IN W CB 3M(9FT) N/O BCR @ NW COR MICHILLINDA AVE & CALIFORNIA BLVD MKD (TE 432) | G 3092 |
| BASELINE (2005) | 716.347 218.343 | CS MON IN WELL 300MM(1FT) E/O CF 15M(49FT) N/O BCR @ NE COR FOOTHILL BLVD & SIERRA MADRE VILLA MKD (BM 10-9A RE 5869 1962) | G 3094 |
| ARCADIA (2005) | 458.400 139.721 | L&PK IN W CB 2M(6FT) S/O BCR @ SW COR BALDWIN AVE & CALLITA AVE | G 3221 |

| QUAD YEAR | ELEV FOOT/METER | DESCRIPTION | BM NUMBER |
|--------------------|--------------------|--|-----------|
| ARCADIA (2005) | 431.323 131.468 | RD HD SPK IN W CB 1.5M(5FT) N/O BCR @ NW COR BALDWIN AVE & LONGDEN AVE | G 3222 |
| ARCADIA (2005) | 429.805 131.005 | L&BN IN W CB 300MM(1FT) S/O BCR & SW COR BALDWIN AVE & LONGDEN AVE MKD (BM) | G 3223 |
| ARCADIA (2005) | 342.245 104.317 | L&BN IN E CB 3M(10FT) N/O BCR @ NE COR BALDWIN AVE & GREEN ST MKD (BM) | G 3225 |
| ARCADIA (2005) | 341.276 104.021 | L&BN IN E CB 2M(6.5FT) S/O BCR @ SE COR BALDWIN AVE & GREEN ST MKD (BM) | G 3226 |
| ARCADIA (2005) | 586.761 178.845 | L&T IN N CB C/L MEDIAN 2M(6FT) S/O C/L HUNTINGTON DR 35M(115FT) E/O C/L LA PRESA DR | G 3227 |
| ARCADIA (2005) | 569.644 173.628 | L&BN IN N CB 6.5M(21FT) E/O BCR @ NE COR HUNTINGTON DR & MADRE ST | G 3228 |
| ARCADIA (2005) | 562.930 171.582 | L&T IN E CB 2M(6FT) N/O BCR @ SE COR HUNTINGTON DR & ROSEMEAD BLVD MKD (BM) | G 3229 |
| ARCADIA (2005) | 554.820 169.110 | L&T IN E CB 11M(35FT) N/O BCR @ NE COR HUNTINGTON DR & MICHILLINDA AVE | G 3230 |
| ARCADIA (2005) | 603.403 183.918 | RD HD SPK IN W CB 2.5M(8FT) S/O BCR @ SW COR SYCAMORE AVE & MICHILLINDA AVE MKD (TE 428) | G 3231 |
| ARCADIA (2005) | 389.008 118.570 | L&T IN S CB 600MM(2FT) W/O BCR @ SW COR ROSEMEAD BLVD & BROADWAY | G 3238 |
| BASELINE (2005) | 318.945 97.215 | L&BN IN N CB 14M(45FT) E/O BCR @ NE COR LOWER AZUSA RD & SANTA ANITA AVE | G 3241 |
| BASELINE (2005) | 334.730 102.026 | L&T IN CB 3FT N/O BCR @ NE COR ROSEMEAD BLVD & MISSION DR | G 3246 |
| ROSEMEAD (2005) | 264.451 80.605 | RDBM TAG IN S CB 10.5M(34FT) W/O BCR @ SW COR MARSHALL BLVD & TEMPLE CITY BLVD | G 3247 |
| ROSEMEAD (2005) | 302.735 92.274 | RDBM TAG IN SW COR OF BRIDGE OVER EATON WASH 10M(33FT) W/O C/L TEMPLE CITY BLVD & 30.5M(100FT) N/O SPRR TRACK | G 3249 |
| ROSEMEAD (2005) | 280.311 85.439 | RDBM TAG IN N CB 300MM(1FT) E/O BCR @ NE COR VALLEY BLVD & ARDEN DR | G 3251 |
| ROSEMEAD (2005) | 323.394 98.571 | RDBM TAG IN W CB 300MM(1FT) N/O BCR @ NW COR VALLEY BLVD & WALNUT GROVE AVE | G 3252 |
| ROSEMEAD (2005) | 286.917 87.453 | RDBM TAG IN E CB 300MM(1FT) N/O BCR @ NE COR ARDEN DR & VENITA ST | G 3254 |
| BASELINE (2005) | 308.700 94.092 | RDBM TAG IN S CB 2M(6.5FT) E/O BCR @ SE COR ARDEN DR & LOWER AZUSA RD | G 3255 |
| BASELINE (2005) | 356.109 108.542 | L&BN IN N CB 600MM(2FT) E/O BCR @ NE COR PECK RD & LIVE OAK AVE | G 3278 |
| ARCADIA (2005) | 510.183 155.504 | RDBM TAG IN S CB 600MM(2FT) W/O BCR @ SW COR DUARTE RD & OAK AVE | G 3589 |
| ARCADIA (2005) | 511.542 155.918 | L&T IN N CB DUARTE RD 10M(32FT) N/O C/L & 13M(42FT) W/O C/L PROD OAK AVE (NR E END CB) | G 3590 |

| QUAD YEAR | ELEV FOOT/METER | DESCRIPTION | BM NUMBER |
|--------------------|--------------------|--|-----------|
| ARCADIA (2005) | 507.885 154.804 | RDBM TAG S CB 300MM(1FT) W/O BCR @ SW COR DUARTE RD & TEMPLE CITY BLVD | G 3591 |
| BASELINE (2005) | 656.527 200.110 | RDBM TAG IN N CB FOOTHILL BLVD 300MM(1FT) E/O BCR SERVICE RD 8M(26FT) N/O C/L & 23M(75.5FT) E/O C/L DON ROBLES DR | G 3594 |
| BASELINE (2005) | 318.054 96.943 | RDBM TAG IN E CB 600MM(2FT) N/O BCR @ NE COR LOWER AZUSA RD & BALDWIN AVE | G 3601 |
| BASELINE (2005) | 697.074 212.469 | L&BN IN S END C. B. 1M(3.3FT) N/O BCR @ NW COR DEL MAR BLVD & SAN GABRIEL BLVD | G 3604 |
| ARCADIA (2005) | 529.730 161.462 | L&T IN W CB 300MM(1FT) S/O BCR @ SW COR SAN GABRIEL BLVD & DUARTE RD | G 3607 |
| ARCADIA (2005) | 434.337 132.386 | L&SPK IN N CB 2M(6.5FT) E/O BCR @ NE COR SAN GABRIEL BLVD & LAS TUNAS DR | G 3608 |
| ARCADIA (2005) | 414.560 126.358 | FC DISC IN SW COR BRIDGE OVER RUBIO WASH 15M(49FT) W/O & 30.5M(100FT) S/O C/L INT SAN GABRIEL BL & WEDGEWOOD PL MKD (RW 58-201 1940) | G 3609 |
| BASELINE (2005) | 309.776 94.420 | L&BN IN W CB 300MM(1FT) S/O BCR @ SW COR LOWER AZUSA RD & SHIRLEY AVE | G 3611 |
| BASELINE (2005) | 333.464 101.640 | CS MON 125MM(0.4FT) UP 2.5M(8.2FT) E/O CF @ NW COR FIRE STA 61M(197FT) N/O C/L CHERRYLEE DR & 15M(49FT) E/O C/L PECK RD MKD (NW COR LOT 5) | G 3616 |
| BASELINE (2005) | 360.600 109.911 | FC MON IN SE RET 1M(3.3FT) S/O CF @ W END OF BRIDGE 19M(62.3FT) E/O C/L MYRTLE AVE & 10M(32.8FT) S/O C/L LONGDEN AVE MKD (BM 067-00565 1965) | G 3619 |
| BASELINE (2005) | 259.838 79.199 | L&BN IN N CB 3.5M(11.5FT) W/O BCR @ NW COR GARVEY AVE & MERCED AVE MKD (BM) | G 3660 |
| BASELINE (2005) | 260.615 79.436 | L&SPK IN N CB 3.5M(11.5FT) E/O BCR @ NE COR GARVEY AVE & MERCED AVE | G 3661 |
| BASELINE (2005) | 267.003 81.383 | RD HD SPK IN S CB 2M(6.5FT) E/O BCR @ SE COR GARVEY AVE & CENTRAL AVE | G 3662 |
| BASELINE (2005) | 269.921 82.272 | RD HD SPK IN W CB 1.5M(5FT) S/O BCR @ SW COR TYLER AVE & GARVEY AVE | G 3664 |
| BASELINE (2005) | 321.141 97.884 | RDBM TAG IN E CB 1M(3.3FT) N/O BCR @ NE COR PECK RD & EMERY ST | G 3667 |
| BASELINE (2005) | 242.494 73.912 | RDBM TAG E END C. B. 13.5M(44FT) W/O BCR @ NW COR GARVEY AVE & ROSEMEAD BLVD | G 4049 |
| BASELINE (2005) | 252.579 76.986 | CSBM MON IN WELL 300MM(1FT) W/O W CF 12.5M(41FT) S/O BCR @ SW COR GARVEY AVE & POTRERO AVE MKD (BM 12-8A 1971 RE 7078) | G 4051 |
| BASELINE (2005) | 282.182 86.009 | CSBM MON IN WELL 300MM(1FT) N/O CF @ BCR @ NW COR SAN GABRIEL BLVD & EMERSON PL MKD (BM 1-25C 1970) | G 4113 |
| ARCADIA (2005) | 399.864 121.879 | CSBM MON @ N END C. B. 6M(20FT) N/O BCR @ NW COR SAN GABRIEL BLVD & ANGELINO AVE MKD (BM 1-28A 1971) | G 4115 |
| ARCADIA (2005) | 433.114 132.014 | CSBM MON IN N END C. B. 13M(42.7FT) S/O BCR @ SW COR SAN GABRIEL BLVD & LAS TUNAS DR MKD (BM 10-1B 1971) | G 4116 |

| QUAD YEAR | ELEV FOOT/METER | DESCRIPTION | BM NUMBER |
|--------------------|--------------------|---|-----------|
| ARCADIA (2005) | 448.333 136.652 | CSBM MON 300MM(1FT) W/O CF 22.5M(74FT) S/O BCR @ SW COR HERMOSA DR & SAN GABRIEL BL MKD (BM 10-1C 1971) | G 4117 |
| ARCADIA (2005) | 485.619 148.017 | CSBM MON 300MM(1FT) W/O CF 1.5M(5FT) S/O BCR @ SW COR SAN GABRIEL BL & LONGDEN AVE MKD (BM 10-2A 1971 RE 5869) | G 4118 |
| ARCADIA (2005) | 533.191 162.517 | CSBM MON IN N END C. B. 4M(13FT) N/O BCR @ NW COR SAN GABRIEL BL & DUARTE RD MKD (BM 10-4A 1975 RE 7078) | G 4119 |
| ARCADIA (2005) | 601.885 183.455 | CSBM MON IN S END C. B. 1.5M(5FT) N/O BCR @ NE COR SAN GABRIEL BLVD & HUNTINGTON DR MKD (BM 10-5A 1966) | G 4120 |
| ARCADIA (2005) | 653.878 199.303 | CSBM MON IN WELL 1M(3.3FT) N/O BCR 600MM(2FT) E/O CF @ SE COR LOMBARDY RD & SAN GABRIEL BL MKD (BM 10-6A 1971) | G 4121 |
| BASELINE (2005) | 664.025 202.395 | RDBM TAG IN S END C. B. 2M(6.5FT) N/O BCR @ NE COR SAN GABRIEL BLVD & CALIFORNIA BLVD | G 4122 |
| BASELINE (2005) | 696.634 212.335 | CSBM MON IN N END C. B. @ NE COR SAN GABRIEL BLVD & DEL MAR BLVD MKD (BM 10-7A 1971 RE 5869) | G 4123 |
| BASELINE (2005) | 744.291 226.861 | CSBM MON IN N END C. B. 4.5M(14.8FT) N/O BCR @ NW COR FOOTHILL BLVD & DAISY AVE MKD (BM 10-8B 1971 RE 5869) | G 4125 |
| BASELINE (2005) | 703.929 214.558 | RDBM TAG IN N CB 300MM(1FT) E/O BCR @ NE COR FOOTHILL BLVD & HALSTEAD ST | G 4127 |
| BASELINE (2005) | 694.076 211.555 | RDBM TAG IN S CB 2M(6.5FT) E/O BCR @ SW COR ROSEMEAD BL & FOOTHILL BLVD | G 4128 |
| BASELINE (2005) | 695.676 212.043 | CSBM MON 300MM(1FT) N/O CF 1M(3.3FT) E/O BCR @ NE COR ROSEMEAD BL & FOOTHILL BL MKD (BM 10-9C 1971 RE 5869) | G 4129 |
| BASELINE (2005) | 681.202 207.631 | CSBM MON IN N END C. B. 3.5M(11.5FT) N/O BCR @ NW COR FOOTHILL BLVD & MICHILLINDA AVE MKD (BM 10-10A 1971) | G 4130 |
| BASELINE (2005) | 677.536 206.514 | RDBM TAG IN S CB 300MM(1FT) E/O BCR @ SE COR FOOTHILL BLVD & MICHILLINDA AVE | G 4131 |
| BASELINE (2005) | 656.593 200.130 | CSBM MON IN W END C. B. 2M(6.5FT) E/O BCR (SERV RD) @ NE COR FOOTHILL BLVD & DON ROBLES DR MKD (BM 10-11A 1971 RE 5869) | G 4132 |
| BASELINE (2005) | 552.316 168.346 | FC BM DISC IN W WINGWALL OF FC CHANNEL 11.5M(37.7FT) N/O C/L FOOTHILL BLVD & 116M(380FT) E/O C/L RANCHO RD MKD (BM 062-31125 1967) | G 4133 |
| BASELINE (2005) | 356.787 108.749 | CSBM MON IN WELL 6.5M(21FT) W/O BCR @ NW COR MISSION DR & BARTLETT AVE MKD (19-2A 1971 RE 7078) | G 4146 |
| BASELINE (2005) | 347.287 105.853 | RD BM TAG IN S CB 1FT E/O BCR @ SE COR MISSION DR & MUSCATEL AVE | G 4148 |
| BASELINE (2005) | 335.708 102.324 | CS BR CAP MON 1FT W/O W CB FACE 48FT N/O BCR @ NW COR MISSION DR & ROSEMEAD BLVD 152FT N & 43FT W/O C/L INT MKD (BM 19-3A 1971 RE 7078) | G 4149 |
| BASELINE (2005) | 316.935 96.602 | CSBM MON NR W END C. B. 10M(32FT) W/O BCR @ SW COR LOWER AZUSA RD & TEMPLE CITY BLVD MKD (BM 19-5B 1975) | G 4150 |
| BASELINE (2005) | 314.967 96.002 | RDBM TAG IN N CB @ W END C. B. 23M(75.5FT) E/O BCR @ NE COR LOWER AZUSA RD & ELLIS LN | G 4152 |
| BASELINE (2005) | 318.021 96.933 | RDBM TAG S CB 300MM(1FT) E/O BCR @ SW COR LOWER AZUSA RD & SANTA ANITA AVE | G 4156 |

| QUAD YEAR | ELEV FOOT/METER | DESCRIPTION | BM NUMBER |
|--------------------|--------------------|--|-----------|
| BASELINE (2005) | 318.965 97.221 | CSBM IN W END C. B. 14M(45FT) E/O BCR @ NE COR LOWER AZUSA RD & SANTA ANITA AVE MKD (BM 19-8A 1971) | G 4157 |
| BASELINE (2005) | 315.189 96.070 | L&BN IN W CB 600MM(2FT) N/O BCR @ SW COR LAMBERT AVE & PECK RD | G 4160 |
| BASELINE (2005) | 324.957 99.047 | RD BM TAG 1FT W/O BCR @ SW COR LOWER AZUSA RD & PECK RD 96FT W & 32FT S/O C/L INT | G 4161 |
| BASELINE (2005) | 325.838 99.316 | CS BM MON FL IN S WALL C. B. 42FT N/O BCR @ NE COR PECK RD & LOWER AZUSA RD 39FT E & 107FT N/O C/L INT MKD (BM 15-4D 1971) | G 4162 |
| BASELINE (2005) | 434.477 132.429 | L&T IN CB RET 5M(16.4FT) N/O BCR @ SW COR MYRTLE AVE & DUARTE RD | G 4163 |
| ARCADIA (2005) | 496.854 151.442 | RDBM TAG IN W CB 300MM(1FT) S/O BCR @ NW COR BALDWIN AVE & L (N BARREL) HUNTINGTON DR | G 4334 |
| ARCADIA (2005) | 481.498 146.761 | CSBM MON IN SE COR C. B. 16M(52.5FT) N/O BCR @ NE COR BALDWIN AVE & DUARTE RD MKD (BM 20-5A 1966 RE 5869) | G 4335 |
| ARCADIA (2005) | 374.776 114.232 | RDBM TAG IN N CB 300MM(1FT) W/O BCR @ NW COR BROADWAY & N ENCINITA AVE | G 4336 |
| ARCADIA (2005) | 645.304 196.689 | RDBM TAG IN N CB 300MM(1FT) W/O BCR @ NW COR COLORADO BLVD & MICHILLINDA AVE | G 4338 |
| ARCADIA (2005) | 642.787 195.922 | RDBM TAG IN E CB 300MM(1FT) S/O BCR @ SE COR COLORADO BLVD & MICHILLINDA AVE | G 4339 |
| ARCADIA (2005) | 544.694 166.023 | L&T IN S CB OF SMALL ISLAND 5M(17FT) W/O BCR 17M(55FT) W/O C/L SUNSET BLVD & 9M(30FT) N/O C/L HUNTINGTON DR (S BBL) | G 4340 |
| ARCADIA (2005) | 544.739 166.037 | L&T IN N CB 1M(4FT) W/O BCR @ NW COR HUNTINGTON DR (N BBL) & SUNSET BLVD | G 4341 |
| ARCADIA (2005) | 508.673 155.044 | L&T IN W CB 1M(3FT) N/O BCR @ NW COR SUNSET BLVD & DUARTE RD | G 4342 |
| ARCADIA (2005) | 440.454 134.251 | L&T IN W CB RET 2M(7FT) N/O BCR @ SW COR LONGDEN AVE & TEMPLE CITY BLVD | G 4343 |
| ARCADIA (2005) | 450.583 137.338 | RAMSET & WASHER IN N CB NR BCR @ NW COR LONGDEN AVE & OAK AVE | G 4344 |
| ARCADIA (2005) | 470.501 143.409 | FC TAG IN C. B. 600MM(2FT) E/O CF @ NE COR LONGDEN AVE & MUSCATEL AVE 11M(37FT) N/O & 6.5M(22FT) E/O C/L INT | G 4345 |
| ARCADIA (2005) | 529.491 161.389 | L&T IN CTR CB RET @ SW COR SUNSET BLVD & FAIRVIEW AVE (16FT N/O BCR) | G 4347 |
| ARCADIA (2005) | 330.053 100.600 | FC TAG IN W CB 1M(4FT) N/O BCR @ NW COR FREER ST & EL MONTE AVE | G 4352 |
| ROSEMEAD (2005) | 279.924 85.321 | RDBM TAG IN N CB 300MM(1FT) W/O BCR @ NW COR VALLEY BLVD & ARDEN DR | G 4354 |
| ROSEMEAD (2005) | 299.117 91.171 | L&SPK IN S CB 5M(16FT) W/O BCR @ SW COR VALLEY BLVD & RIO HONDO AVE | G 4357 |
| ROSEMEAD (2005) | 274.643 83.711 | L&T IN W CB 300MM(1FT) S/O BCR @ SW COR TEMPLE CITY BLVD & GUESS ST | G 4358 |

| QUAD YEAR | ELEV FOOT/METER | DESCRIPTION | BM NUMBER |
|--------------------|--------------------|--|-----------|
| ROSEMEAD (2005) | 262.450 79.995 | L&T IN W CB TEMPLE CITY BLVD & 10.5M(34FT) S/O C/L PROD LOFTUS DR | G 4359 |
| ROSEMEAD (2005) | 261.122 79.590 | L&BN IN W CB 2M(6.5FT) N/O BCR @ NW COR TEMPLE CITY BLVD & OLNEY ST | G 4360 |
| ARCADIA (2005) | 562.226 171.367 | CSBM MON IN E END C. B. 11M(35FT) W/O BCR @ NW COR CALIFORNIA BLVD & MICHILLINDA AVE MKD (BM 20-7A 1969) | G 4538 |
| BASELINE (2005) | 306.972 93.565 | RDBM TAG IN E CB 300MM(1FT) N/O BCR @ NE COR LOWER AZUSA RD & EL MONTE AVE | G 4539 |
| BASELINE (2005) | 307.132 93.614 | L&T IN W CB 1M(3FT) N/O BCR @ NW COR LOWER AZUSA RD & EL MONTE AVE | G 4540 |
| ARCADIA (2005) | 387.210 118.022 | L&T IN S CB 1M(4FT) E/O BCR @ SE COR LIVE OAK AVE & ENCINITA AVE | G 4541 |
| ARCADIA (2005) | 376.448 114.742 | CSBM MON IN E END C. B. 3.5M(12FT) W/O BCR @ SW COR LIVE OAK AVE & BALDWIN AVE MKD (20-2A 1966) | G 4542 |
| BASELINE (2005) | 638.647 194.660 | RDBM TAG IN SE COR EDISON BOX 600MM(2FT) W/O CF 2M(6.5FT) N/O BCR @ NW COR FOOTHILL BLVD & BALDWIN AVE | G 4545 |
| BASELINE (2005) | 351.909 107.262 | L&T IN E CB 1M(3.3FT) N/O BCR @ NE COR SAN GABRIEL BLVD & CHESTNUT AVE | G 4572 |
| BASELINE (2005) | 546.976 166.719 | DPW BM TAG IN S END C. B. 6M(20FT) N/O BCR @ NE COR FOOTHILL BLVD & SANTA ANITA AVE | G 4574 |
| BASELINE (2005) | 276.456 84.264 | DPW BM TAG IN E CB 300MM(1FT) S/O BCR @ NE COR PECK RD & GARVEY AVE | G 4582 |
| BASELINE (2005) | 299.747 91.363 | DPW BM TAG IN N CB 600MM(2FT) W/O BCR @ NE COR PECK RD & FOREST GROVE ST | G 4583 |
| BASELINE (2005) | 312.195 95.157 | DPW BM TAG IN E CB 600MM(2FT) N/O BCR @ NE COR PECK RD & BAYSE ST | G 4584 |
| BASELINE (2005) | 518.748 158.115 | DPW BM TAG IN E CB 300MM(1FT) S/O BCR @ SE COR MYRTLE AVE & CHESTNUT AVE | G 4586 |
| BASELINE (2005) | 578.660 176.376 | DPW BM TAG IN W CB 300MM(1FT) N/O BCR @ NW COR MYRTLE AVE & FOOTHILL BLVD | G 4587 |
| BASELINE (2005) | 339.342 103.432 | L&SPK IN W CB ROSEMEAD BLVD 12M(40FT) W/O C/L & 17.5M(57.4FT) N/O C/L PROD LOWER AZUSA RD | G 4588 |
| BASELINE (2005) | 270.320 82.394 | DPW BM TAG IN S CB 2M(6.5FT) E/O BCR @ SE COR GARVEY AVE & TYLER AVE | G 4592 |
| ARCADIA (2005) | 551.936 168.231 | DPW BM TAG IN W CB 2M(6.5FT) N/O BCR @ NW COR FOOTHILL BLVD & MAYFLOWER AVE (@ S END C. B.) | G 4720 |
| ARCADIA (2005) | 510.978 155.747 | DPW BM TAG IN E CB 3.5M(11.5FT) N/O BCR @ NE COR FOOTHILL BLVD & MC KINLEY PL | G 4721 |
| ARCADIA (2005) | 512.857 156.319 | DPW BM TAG IN N CB 600MM(2FT) E/O BCR @ NE COR FOOTHILL BLVD & FIFTH AVE | G 4722 |
| ARCADIA (2005) | 514.030 156.677 | CSBM MON E END C. B. 10M(33FT) W/O BCR @ SW COR FOOTHILL BLVD & FIFTH ST MKD (BM 11-3A 1977 RE 22726) | G 4723 |

| QUAD YEAR | ELEV FOOT/METER | DESCRIPTION | BM NUMBER |
|--------------------|--------------------|--|-----------|
| ARCADIA (2005) | 541.792 165.139 | FC BM MON @ SE COR OF BRIDGE OVER SANTA ANITA WASH 15M(49FT) S/O C/L FOOTHILL BLVD & 84M(276FT) E/O C/L HIGHLAND OAKS MKD (BM 63-70) | G 4724 |
| ARCADIA (2005) | 409.167 124.714 | DPW BM TAG IN W CB 1.5M(5FT) S/O BCR @ SW COR ROSEMEAD BLVD & LAS TUNAS DR | G 4725 |
| ARCADIA (2005) | 462.646 141.015 | DPW BM TAG IN W CB 2M(7FT) S/O BCR @ SW COR ROSEMEAD BLVD & LONGDEN AVE | G 4726 |
| ARCADIA (2005) | 464.154 141.475 | DPW BM TAG IN W CB 300MM(1FT) S/O BCR @ NW COR ROSEMEAD BLVD & LONGDEN AVE | G 4727 |
| ARCADIA (2005) | 530.783 161.783 | DPW BM TAG W CB 300MM(1FT) N/O BCR @ NW COR SUNSET BLVD & FAIRVIEW AVE | G 4728 |
| ARCADIA (2005) | 401.774 122.461 | DPW BM TAG IN N CB @ NW COR BROADWAY & WALNUT GROVE AVE 14M(47FT) W/O & 7.5M(25FT) N/O C/L INT (2.5M(9FT) W/O E END C. B.) | G 4729 |
| BASELINE (2005) | 266.969 81.372 | L&T IN S CB 2.5M(8FT) E/O BCR @ SE COR GARVEY AVE & LEXINGTON AVE | G 4825 |
| BASELINE (2005) | 252.841 77.066 | DPW BM TAG IN N CB 3M(10FT) W/O BCR @ NW COR GARVEY AVE & POTERO AVE | G 4826 |
| BASELINE (2005) | 247.071 75.307 | L&T IN N CB (DEP) GARVEY AVE ON C/L PROD CHICO AVE | G 4827 |
| BASELINE (2005) | 242.956 74.053 | ARMY CORP OF ENG MON IN N CB 15M(49FT) E/O BCR @ NE COR GARVEY AVE & ROSEMEAD BLVD MKD (WS 118 1981 LADO) @ E END C. B. | G 4828 |
| BASELINE (2005) | 246.633 75.174 | L&SPK IN W CB 9.5M(31FT) N/O BCR @ NW COR GARVEY AVE & ROSEMEAD PL | G 4829 |
| BASELINE (2005) | 249.154 75.942 | DPW BM TAG IN N CB 1M(3.3FT) W/O BCR @ NW COR GARVEY AVE & IVAR AVE | G 4830 |
| BASELINE (2005) | 250.628 76.392 | DPW BM TAG IN N CB 3M(10FT) W/O BCR @ NW COR GARVEY AVE & MUSCATEL AVE | G 4831 |
| BASELINE (2005) | 260.123 79.286 | L&BR IN CB RET 3M(10FT) W/O BCR @ NE COR GARVEY AVE & WALNUT GROVE | G 4832 |
| BASELINE (2005) | 260.711 79.465 | DPW BM TAG IN N CB 1M(3.3FT) W/O BCR @ NW COR GARVEY AVE & WALNUT GROVE | G 4833 |
| BASELINE (2005) | 266.132 81.117 | L&BR IN N CB GARVEY AVE & 9M(29.5FT) E/O C/L PROD DELTA AVE | G 4834 |
| BASELINE (2005) | 289.905 88.363 | L&BR IN S CB STEWART ST @ E END C. B. 600MM(2FT) W/O BCR 4.5M(15FT) S/O C/L & 25.5M(84FT) W/O C/L PECK RD | G 4897 |
| BASELINE (2005) | 298.528 90.992 | L&BR IN N CB 300MM(1FT) E/O BCR @ NW COR PECK RD & RAMONA BLVD | G 4898 |
| BASELINE (2005) | 332.201 101.255 | L&BR IN S CB 1M(3.3FT) E/O BCR @ SE COR PECK RD & CHERRY LEE DR | G 4899 |
| BASELINE (2005) | 336.294 102.503 | DPW BM TAG IN E CB 1M(3.3FT) S/O BCR @ SE COR PECK RD & RIO HONDO PKWY | G 4900 |

| QUAD YEAR | ELEV FOOT/METER | DESCRIPTION | BM NUMBER |
|--------------------|--------------------|---|-----------|
| BASELINE (2005) | 334.393 101.923 | DPW BM TAG IN E CB 1M(3.3FT) S/O BCR @ SE COR PECK RD & CLARK ST | G 4901 |
| BASELINE (2005) | 378.267 115.296 | DPW BM TAG IN E CB 1M(3.3FT) S/O BCR @ SE COR PECK RD & ANDRE ST | G 4903 |
| BASELINE (2005) | 400.382 122.037 | DPW BM TAG IN E CB 1M(3.3FT) S/O BCR @ SE COR MYRTLE AVE & KRUSE AVE | G 4904 |
| BASELINE (2005) | 364.071 110.969 | L&T IN N CB 2M(6.5FT) W/O BCR @ NW COR MISSION DR & EARLE AVE | G 5145 |
| BASELINE (2005) | 358.330 109.219 | DPW BM TAG IN W CB 1M(3.3FT) S/O BCR @ SW COR MISSION DR & WALNUT GROVE AVE | G 5146 |
| BASELINE (2005) | 355.861 108.467 | L&BR IN N CB MISSION DR ON C/L PROD BARTLETT AVE S | G 5147 |
| BASELINE (2005) | 349.282 106.461 | L&BR IN N CB 1M(3.3FT) W/O BCR @ NW COR MISSION DR & MUSCATEL AVE | G 5148 |
| BASELINE (2005) | 336.050 102.428 | RAM SET&W IN W CB 1M(3.3FT) N/O BCR @ NW COR SULTAN AVE & LOWER AZUSA RD | G 5149 |
| BASELINE (2005) | 325.008 99.063 | DPW BM TAG IN S CB 300MM(1FT) W/O BCR @ SW COR LOWER AZUSA RD & ENCINITA AVE | G 5150 |
| BASELINE (2005) | 324.861 99.018 | DPW BM TAG IN S CB 3M(10FT) E/O BCR @ SE COR LOWER AZUSA RD & ENCINITA AVE | G 5151 |
| BASELINE (2005) | 318.096 96.956 | DPW BM TAG IN W CB 300MM(1FT) S/O BCR @ SW COR LOWER AZUSA RD & CLOVERLY AVE | G 5152 |
| BASELINE (2005) | 310.767 94.722 | L&SPK IN E ABUT @ SE COR BRIDGE OVER RIO HONDO RIVER 8M(26FT) S/O C/L LOWER AZUSA RD & 128M(420FT) E/O DALEVIEW AVE | G 5154 |
| BASELINE (2005) | 320.339 97.640 | L&BR IN S CB 600MM(2FT) E/O BCR @ SE COR LOWER AZUSA RD & CEDAR AVE | G 5155 |
| BASELINE (2005) | 345.733 105.380 | L&T IN N CB 1.5M(5FT) W/O BCR @ NW COR SAN GABRIEL BLVD & WELLS ST | G 5156 |
| BASELINE (2005) | 344.487 105.000 | L&SPK IN W CB 3M(10FT) S/O BCR @ SW COR SAN GABRIEL BLVD & WELLS ST | G 5157 |
| BASELINE (2005) | 329.207 100.343 | DPW BM TAG IN S CB 1M(3.3FT) E/O BCR @ SE COR VALLEY BLVD & SAN GABRIEL BLVD | G 5158 |
| BASELINE (2005) | 314.514 95.864 | FC TAG IN W CB 1.5M(5FT) N/O BCR @ NW COR SAN GABRIEL BLVD & NORWOOD PL | G 5159 |
| BASELINE (2005) | 297.188 90.583 | LACO BM TAG IN N CB 1M(3.3FT) W/O BCR @ NW COR HELLMAN AVE & SAN GABRIEL BL | G 5160 |
| BASELINE (2005) | 296.347 90.327 | LACO BM TAG IN W CB 3M(10FT) S/O BCR @ SW COR HELLMAN AVE & SAN GABRIEL BLVD | G 5161 |
| BASELINE (2005) | 282.129 85.993 | L&BR IN W CB 300MM(1FT) S/O BCR @ SW COR EMERSON PL & SAN GABRIEL BLVD | G 5162 |
| ROSEMEAD (2005) | 313.075 95.426 | L&BR IN W CB 1M(3.3FT) S/O BCR @ SW COR VALLEY BLVD & HART AVE | G 5166 |

| QUAD YEAR | ELEV FOOT/METER | DESCRIPTION | BM NUMBER |
|--------------------|--------------------|--|-----------|
| ROSEMEAD (2005) | 276.234 84.196 | L&PK IN N CB @ BCR @ NE COR VALLEY BLVD & GIBSON RD | G 5169 |
| ROSEMEAD (2005) | 284.972 86.860 | FC BR DISC @ NE COR BRIDGE OVER RIO HONDO RIVER 11.5M(38FT) N/O C/L VALLEY BLVD MKD (BM 062-00100 1965) | G 5170 |
| ROSEMEAD (2005) | 287.507 87.632 | DPW BM TAG IN N CB 300MM(1FT) W/O BCR @ NW COR VALLEY BLVD & MONTEREY AVE | G 5171 |
| ROSEMEAD (2005) | 289.104 88.119 | L&BR IN E CB 1M(3.3FT) N/O BCR @ NE COR VALLEY BLVD & TYLER AVE | G 5172 |
| ROSEMEAD (2005) | 303.700 92.568 | L&T IN E CB ROSEMEAD BLVD ON C/L PROD RALPH ST FROM THE W (3FT S/O BCR) | G 5173 |
| ROSEMEAD (2005) | 284.534 86.726 | FC BM MON IN N CB 10.5M(34FT) W/O BCR @ NW COR ROSEMEAD BLVD & GLENDON WAY MKD (BM 058-00592 1967) | G 5174 |
| ROSEMEAD (2005) | 288.238 87.855 | L&T IN W CB TEMPLE CITY BLVD ON C/L PROD ABILENE ST | G 5175 |
| ROSEMEAD (2005) | 277.058 84.448 | L&SPK IN N CB 1M(3FT) E/O BCR @ NE COR ELLIS LN & GUESS ST | G 5176 |
| ROSEMEAD (2005) | 271.234 82.672 | L&BR IN W CB 300MM(1FT) N/O BCR @ NW COR RIO HONDO AVE & GLENDON WAY | G 5178 |
| ROSEMEAD (2005) | 274.105 83.547 | L&T IN E CB RIO HONDO AVE ON C/L PROD MARSHALL ST | G 5179 |
| ROSEMEAD (2005) | 289.973 88.384 | L&FC TAG IN N CB 1M(3.3FT) E/O BCR @ NE COR ARDEN DR & BISBY ST | G 5180 |
| ROSEMEAD (2005) | 283.689 86.469 | DPW BM TAG IN W CB 1M(3.3FT) S/O BCR @ SW COR ARDEN DR & ROSE ST | G 5181 |
| BASELINE (2005) | 547.090 166.754 | L&BR IN N CB @ BCR @ NW COR SANTA ANITA AVE & FOOTHILL BLVD | G 5184 |
| BASELINE (2005) | 560.710 170.905 | L&BR IN S CB @ W END C. B. 2M(6.5FT) W/O BCR @ SW COR RANCHO RD & FOOTHILL BLVD | G 5185 |
| BASELINE (2005) | 622.084 189.612 | L&BN IN N CB FOOTHILL BLVD 10M(33FT) N/O C/L & 32M(105FT) E/O C/L PROD BALDWIN AVE (FROM THE S) | G 5186 |
| BASELINE (2005) | 637.631 194.351 | DPW BM TAG IN S CB (SERV RD) 2M(6.5FT) E/O BCR @ NE COR FOOTHILL BLVD & BALDWIN AVE S | G 5187 |
| BASELINE (2005) | 742.453 226.300 | RAMSET IN N CB 300MM(1FT) W/O BCR @ NE COR DAISY AVE & FOOTHILL BLVD | G 5188 |
| BASELINE (2005) | 730.494 222.655 | CITY OF PASADENA L&TAG IN SW CB RET 1.5M(5FT) N/O BCR @ SW COR WALNUT ST & DAISY AVE | G 5189 |
| BASELINE (2005) | 722.431 220.198 | DPW BM TAG IN S CB 2M(6.5FT) W/O BCR @ SW COR COLORADO BLVD & SAN GABRIEL BLVD | G 5190 |
| BASELINE (2005) | 720.743 219.683 | DPW BM TAG IN E CB 1M(3.3FT) S/O BCR @ SE COR COLORADO BLVD & SAN GABRIEL BLVD | G 5191 |
| ARCADIA (2005) | 655.480 199.791 | LACO DPW BM TAG IN E CB RET 300MM(1FT) S/O BCR @ NE COR SAN GABRIEL BLVD & LOMBARDY RD | G 5192 |

| QUAD YEAR | ELEV FOOT/METER | DESCRIPTION | BM NUMBER |
|--------------------|--------------------|--|-----------|
| ARCADIA (2005) | 635.113 193.583 | L&BN IN N CB 3.5M(11.5FT) W/O BCR @ NW COR SHAKESPEARE DR & SAN GABRIEL BLVD | G 5193 |
| ARCADIA (2005) | 556.003 169.470 | L&BR IN W CB 13M(43FT) N/O BCR @ NW COR SAN GABRIEL BLVD & ROSE AVE | G 5194 |
| ARCADIA (2005) | 570.849 173.995 | DPW BM TAG IN E CB @ N END C. B. 6M(20FT) N/O BCR @ NE COR FOOTHILL BLVD & MAGNOLIA AVE | G 5195 |
| ARCADIA (2005) | 397.944 121.294 | L&SPK IN W CB 6M(20FT) S/O BCR @ SW COR BROADWAY & MUSCATEL AVE S | G 5196 |
| ARCADIA (2005) | 347.033 105.776 | L&SPK IN S CB 2M(6.5FT) W/O BCR @ SW COR LIVE OAK AVE & LENORE AVE | G 5197 |
| ARCADIA (2005) | 335.921 102.389 | DPW BM TAG IN E CB 1M(3.3FT) S/O BCR @ SE COR BALDWIN AVE & LA ROSA DR | G 5198 |
| ARCADIA (2005) | 391.427 119.307 | DPW BM TAG IN W CB 1M(3.3FT) S/O BCR @ SW COR BALDWIN AVE & LAS TUNAS DR | G 5199 |
| ARCADIA (2005) | 410.135 125.010 | L&BR IN W CB 6M(20FT) S/O BCR @ SW COR BALDWIN AVE & GARIBALDI AVE | G 5200 |
| ARCADIA (2005) | 447.407 136.370 | SPK&W IN E CB 1M(3.3FT) N/O BCR @ NE COR BALDWIN AVE & LEMON AVE E | G 5201 |
| ARCADIA (2005) | 519.215 158.257 | L&T IN W CB 300MM(1FT) N/O BCR @ NW COR BALDWIN AVE & ENT TO ARBORETUM | G 5204 |
| ARCADIA (2005) | 540.401 164.715 | L&SPK IN W CB BALDWIN AVE 12M(40FT) W/O C/L & 31M(102FT) N/O C/L STANFORD DR MKD (BM) | G 5205 |
| ARCADIA (2005) | 561.165 171.044 | L&BN IN N CB @ BCR @ NW COR HUNTINGTON DR (N BBL) & LOTUS AVE | G 5206 |
| ARCADIA (2005) | 580.510 176.940 | FC BM MON IN E WINGWALL OF BRIDGE OVER EATON WASH 2M(6.5FT) N/O CF & 11M(36FT) N/O C/L HUNTINGTON DR (N BBL) MKD (BM 059-04000 1965) | G 5207 |
| ARCADIA (2005) | 592.380 180.558 | L&T IN NW CB RET HUNTINGTON DR (SERV RD) 1M(3FT) E/O BCR 4M(13FT) N/O C/L & 13M(43FT) W/O C/L WINIFRED AVE | G 5208 |
| ARCADIA (2005) | 435.329 132.689 | LACO DPW TAG IN N CB 300MM(1FT) W/O BCR @ NW COR LONGDEN AVE & GOLDEN WEST AVE | G 5209 |
| ARCADIA (2005) | 364.649 111.145 | DPW BM TAG IN N CB 1M(3.3FT) E/O BCR @ NE COR ROSEMEAD BLVD & PENTLAND ST | G 5211 |
| ROSEMEAD (2005) | 328.257 100.053 | LACO BM TAG IN S CB 2M(6.5FT) E/O BCR @ SE COR VALLEY BLVD & DELTA AVE | G 5407 |
| ROSEMEAD (2005) | 322.823 98.397 | LACO BM TAG IN S CB 4M(13FT) E/O BCR @ SE COR VALLEY BLVD & WALNUT GROVE AVE | G 5408 |
| ROSEMEAD (2005) | 320.122 97.573 | LACO BM TAG IN N CB 300MM(1FT) W/O BCR @ NW COR VALLEY BLVD & ROSEMEAD BLVD (@ E END C. B.) | G 5409 |
| ROSEMEAD (2005) | 298.883 91.100 | LACO BM TAG IN N CB 1M(3.3FT) W/O BCR @ NW COR VALLEY BLVD & RIO HONDO AVE | G 5410 |
| ROSEMEAD (2005) | 289.376 88.202 | LS TAG #5301 IN S CB VALLEY BLVD ON C/L PROD MERWYN C. GILL WY (FORMERLY EASY ST) | G 5411 |

| QUAD YEAR | ELEV FOOT/METER | DESCRIPTION | BM NUMBER |
|--------------------|--------------------|---|-----------|
| ROSEMEAD (2005) | 284.182 86.619 | L&SPK IN NE CB RET 3M(10FT) S/O BCR @ NE COR VALLEY BLVD & TEMPLE CITY BL | G 5412 |
| ROSEMEAD (2005) | 284.908 86.840 | LACO FC MON IN NW COR BRIDGE OVER RIO HONDO RIVER 11.5M(38FT) N/O C/L VALLEY BLVD MKD (BM 062-00070 1965) | G 5413 |
| ROSEMEAD (2005) | 285.023 86.875 | L&TAG(NO#) IN SE COR C. B. 2M(6.5FT) W/O BCR @ NW COR VALLEY BLVD & JOHNSON AVE | G 5415 |
| ROSEMEAD (2005) | 269.855 82.252 | L&BR IN E CB RIO HONDO AVE & 7M(23FT) N/O C/L PROD GLENDON WAY | G 5418 |
| ROSEMEAD (2005) | 263.493 80.313 | L&T IN W CB RIO HONDO AVE ON C/L PROD OLNEY ST | G 5419 |
| ROSEMEAD (2005) | 298.923 91.112 | LACO BM TAG IN E CB @ S END C. B. 2.5M(8FT) N/O BCR @ NE COR ARDEN DR & ARDEN WAY | G 5420 |
| ARCADIA (2005) | 524.708 159.931 | LACO BM TAG IN N CB FOOTHILL BLVD & 10M(32.8FT) E/O C/L PROD NORTH VIEW AVE | G 5421 |
| ARCADIA (2005) | 509.181 155.199 | LACO BM TAG IN S CB FOOTHILL BLVD & 5M(16.4FT) W/O C/L PROD MCKINLEY PL | G 5422 |
| ARCADIA (2005) | 536.981 163.672 | LACO BM TAG IN N CB 1M(3.3FT) E/O BCR @ NE COR FOOTHILL BLVD & MAUNA LOA DR | G 5423 |
| ARCADIA (2005) | 550.885 167.910 | CS MON 500MM(1.6FT) S/O CF 8M(26FT) E/O BCR @ SE COR FOOTHILL BLVD & MAYFLOWER AVE MKD (RM NO 2 1959 SIERRA MADRE K6 RE 5869) | G 5424 |
| ARCADIA (2005) | 488.243 148.817 | LACO BM TAG IN E CB @ N END C. B. 6M(20FT) N/O BCR @ NE COR BALDWIN AVE & FAIRVIEW AVE | G 5426 |
| ARCADIA (2005) | 504.896 153.893 | LACO BM TAG IN E CB 1M(3.3FT) S/O BCR @ SE COR BALDWIN AVE & NLY ENT TO SANTA ANITA MALL (OPP HSE #307) | G 5427 |
| ARCADIA (2005) | 352.810 107.537 | LS TAG #4743 IN W CB 2.5M(8FT) S/O BCR @ SW COR LIVE OAK AVE (W) & EL MONTE AVE | G 5428 |
| ARCADIA (2005) | 354.234 107.971 | SM PK NAIL IN E CB 3M(10FT) N/O BCR @ NE COR LIVE OAK AVE (E) & EL MONTE AVE 24.5M(80FT) N/O & 8.5M(28FT) E/O C/L INT | G 5429 |
| ARCADIA (2005) | 389.350 118.674 | L&BRAD IN N CB 2M(6.5FT) E/O BCR @ NW COR ROSEMEAD BLVD & BROADWAY | G 5430 |
| ARCADIA (2005) | 378.808 115.461 | RAMSET&W IN NE CB RET 3M(10FT) W/O BCR @ BROADWAY & NOEL DR | G 5431 |
| ARCADIA (2005) | 387.677 118.164 | L&T IN W CB ENCINITA AVE ON C/L PROD LIVE OAK AVE | G 5432 |
| ARCADIA (2005) | 383.764 116.972 | RAMSET&W IN N CB 7M(23FT) W/O BCR @ NW COR TEMPLE CITY BLVD & LIVE OAK AVE | G 5433 |
| ARCADIA (2005) | 379.950 115.809 | RAMSET&W IN N CB LIVE OAK AVE 1M(3.3FT) W/O C/L PROD CAMBURY AVE | G 5434 |
| ARCADIA (2005) | 345.168 105.208 | LACO BM TAG IN S CB 1M(3.3FT) W/O BCR @ SW COR LIVE OAK AVE & TYLER AVE | G 5435 |
| ARCADIA (2005) | 410.958 125.260 | LACO BM TAG IN E CB 1M(3FT) N/O BCR @ NE COR ROSEMEAD BLVD & LAS TUNAS DR | G 5436 |

| QUAD YEAR | ELEV FOOT/METER | DESCRIPTION | BM NUMBER |
|--------------------|--------------------|--|-----------|
| ARCADIA (2005) | 486.651 148.332 | L&SPK IN E CB 1.5M(5FT) N/O BCR @ NE COR SAN GABRIEL BLVD & LONGDEN AVE | G 5437 |
| ARCADIA (2005) | 441.055 134.434 | LACO BM TAG IN S CB 1M(3.3FT) E/O BCR @ SE COR LONGDEN AVE & TEMPLE CITY BLVD | G 5438 |
| ARCADIA (2005) | 434.223 132.352 | LACO BM TAG IN W CB 400MM(1.3FT) S/O BCR @ SW COR LONGDEN AVE & GOLDEN WEST AVE | G 5439 |
| ARCADIA (2005) | 628.504 191.569 | L&T IN W CB MICHILLINDA AVE 2.5M(8FT) S/O C/L PROD VOLANTE DR | G 5440 |
| ARCADIA (2005) | 502.912 153.288 | L&T IN W CB 1M(3.3FT) N/O BCR @ NW COR HUNTINGTON DR (N BRL) & OLD RANCH RD | G 5441 |
| BASELINE (2005) | 439.506 133.962 | L&T IN W CB 600MM(2FT) N/O BCR @ NW COR MYRTLE AV & DUARTE RD 19M(62.3FT) N/O & 13M(42.7FT) W/O C/L INT | G 5456 |
| BASELINE (2005) | 360.688 109.938 | L&T IN E CB @ BCR @ NE COR MYRTLE AV & LONGDEN AV 17M(55.8FT) E/O & 11M(36.1FT) N/O C/L INT | G 5457 |
| BASELINE (2005) | 501.918 152.985 | L&DPW BM TAG 900MM(3FT) S/O BCR @ SE COR MYRTLE AV & LEMON AV | G 5524 |
| BASELINE (2005) | 594.991 181.354 | L&DPW BM TAG IN N CB FOOTHILL BL 12.2M(40FT) E/O C/L PROD BURNELL OAKS LN | G 5525 |
| ARCADIA (2005) | 386.333 117.755 | L&T 2.1M(7FT) S/O BCR @ SW COR EL MONTE AV & SAN GABRIEL BL | G 5527 |
| BASELINE (2005) | 306.907 93.546 | L&LS#5301 TAG 600MM(2FT) W/O BCR @ NW COR DOREEN AV & LOWER AZUSA RD | G 5528 |
| BASELINE (2005) | 306.862 93.532 | L&TAG(NO#) 3M(10FT) N/O BCR @ NE COR DOREEN AV & LOWER AZUSA RD | G 5529 |
| BASELINE (2005) | 275.868 84.085 | L&DPW BM TAG 300MM(1FT) W/O BCR @ NW COR SAN GABRIEL BL & GARVY AV | G 5530 |
| BASELINE (2005) | 266.803 81.322 | L&LS#6771 TAG 900MM(3FT) W/O BCR @ NW COR GARVY AV & SANTA ANITA AV | G 5531 |
| ARCADIA (2005) | 361.204 110.095 | SPK IN N CB 1.5M(5FT) W/O ECR @ NW COR BALDWIN AV & DAINES DR(W) | G 5562 |
| ARCADIA (2005) | 495.089 150.904 | L&LS#2723 TAG IN E CB 3.4M(11FT) S/O ECR IN THE RETURN @ NE COR BALDWIN AV & HUNINGTON DR | G 5563 |
| ARCADIA (2005) | 481.131 146.649 | L&DPW TAG IN S CB 300MM(1FT) W/O BCR @ SW COR BALDWIN AV & DUARTE RD | G 5564 |
| ARCADIA (2005) | 453.277 138.159 | L&LS#6998 IN W CB ROSEMEAD BL @ P/L TO HSE#6169 & HSE#6203 | G 5565 |
| ROSEMEAD (2005) | 286.704 87.388 | L&T IN E CB @ BCR @ SE COR ARDEN DR & VENITA ST | G 5566 |
| ROSEMEAD (2005) | 287.805 87.723 | L&T IN E CB 13M(4FT) N/O ECR @ NE COR VALLY BL & RAMONA BL (@ S END C.B.) | G 5567 |
| ROSEMEAD (2005) | 284.438 86.697 | L&T IN S CB 2.1M(7FT) E/O BCR @ SW COR VALLEY BL & TEMPLE CITY BL | G 5568 |

| QUAD YEAR | ELEV FOOT/METER | DESCRIPTION | BM NUMBER |
|----------------------|--------------------|---|-----------|
| ROSEMEAD (2005) | 252.577 76.986 | LACFC BRASS CAP MON ON E CB (SERVICE RD) ROSEMEAD BL 6.1M(20FT) S/O BCR @ SE COR TELSTAR AV MKD (BM 058-00250) | G 5569 |